

# PLAN TYPES

# TERMINOLOGY

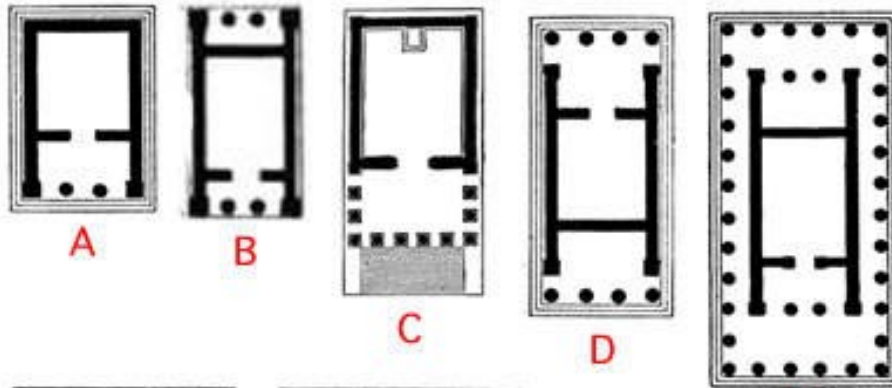

A

B

C

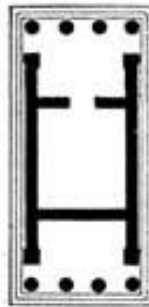

D

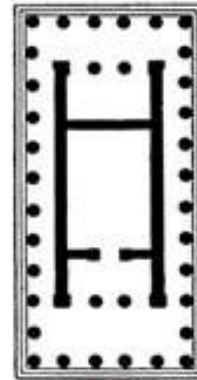

E

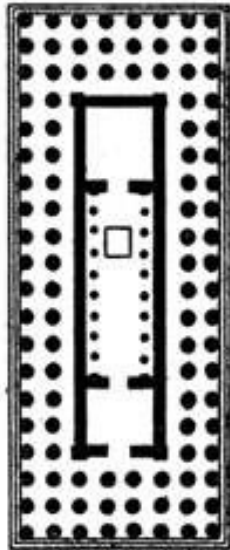

F

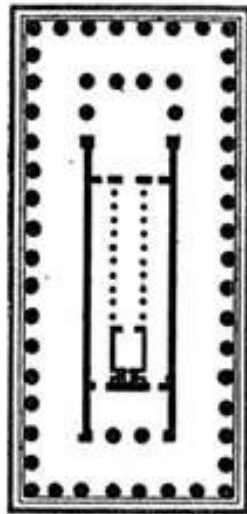

G



F

- A - Temple in Antis
- B - Double Anta Temple
- C - Prostyle
- D - Amphi-Prostyle
- E - Peripteral
- F - Dipteral
- G - Pseudodipteral
- F - Monopteral / Tholos

# CELLA + PERISTYLE / PROSTASIS



Tholos



Temple  
*in antis*

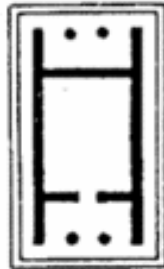

Double Temple  
*in antis*



Tetrastyle  
Prostyle

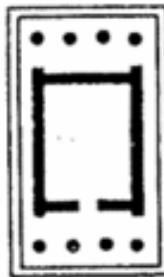

Tetrastyle  
Amphiprostyle

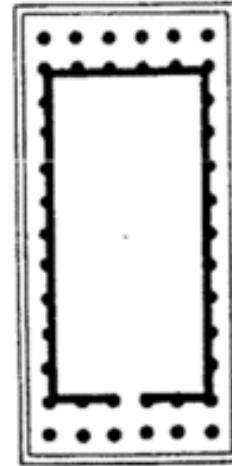

Hexastyle  
Pseudoperipteral

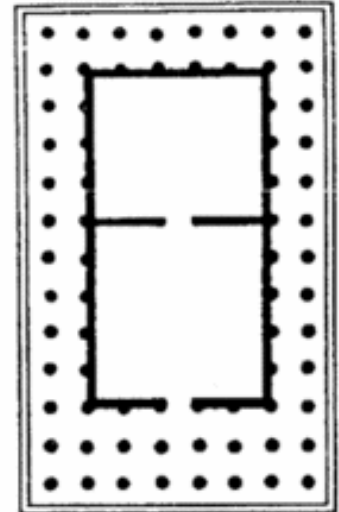

Oktastyle  
Pseudodipteral

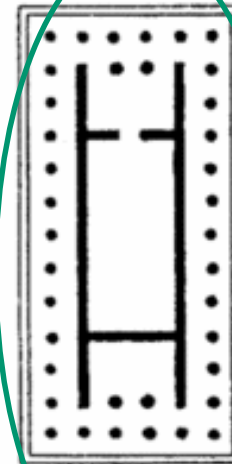

Hexastyle  
Peripteral

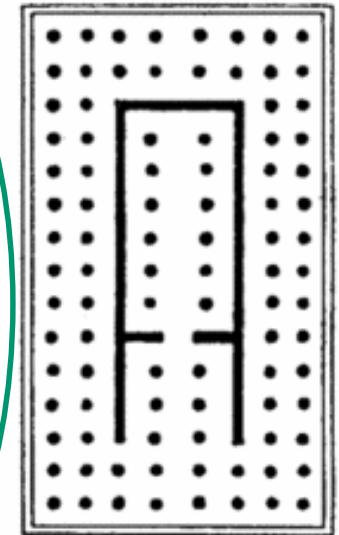

Oktastyle  
Dipteral



# PSEUDO-PERIPTERAL EPIDAUROS, 300 BC

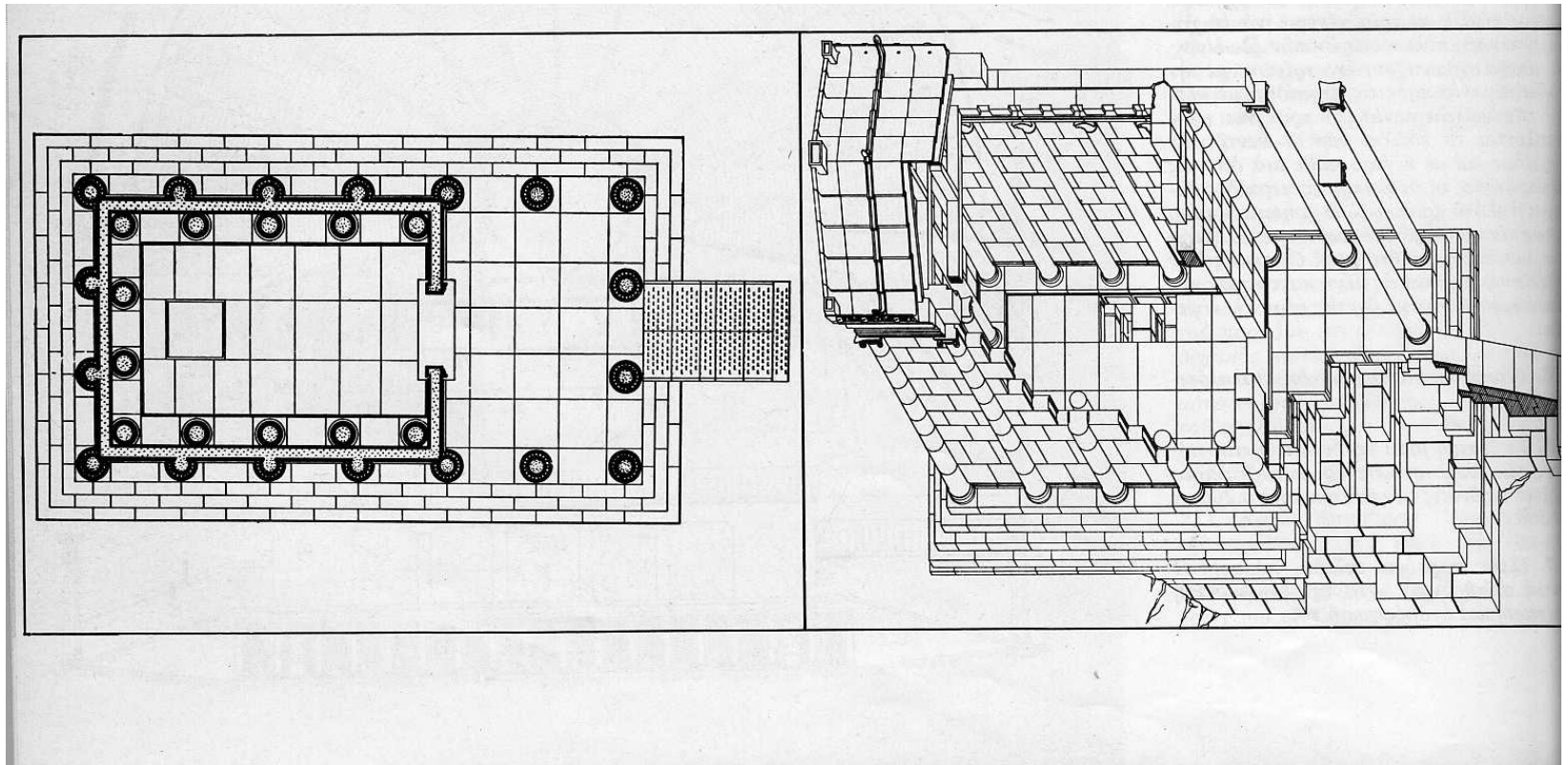



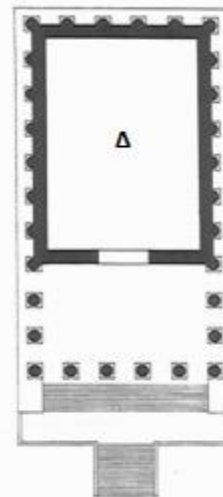
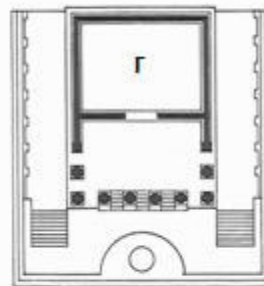
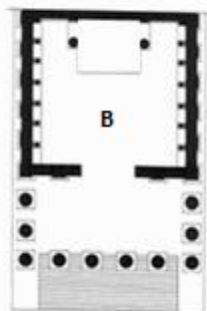
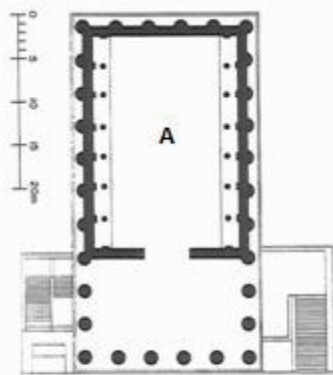

# EXERCISE

---

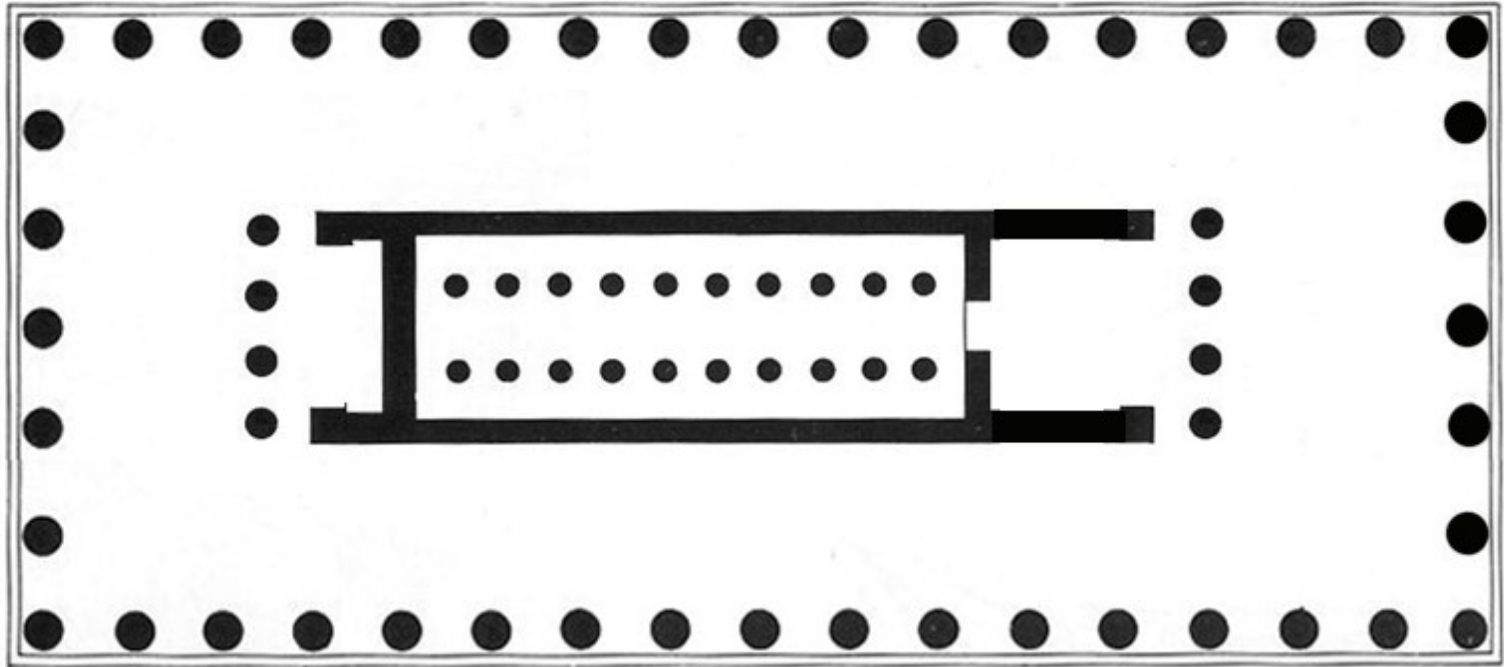



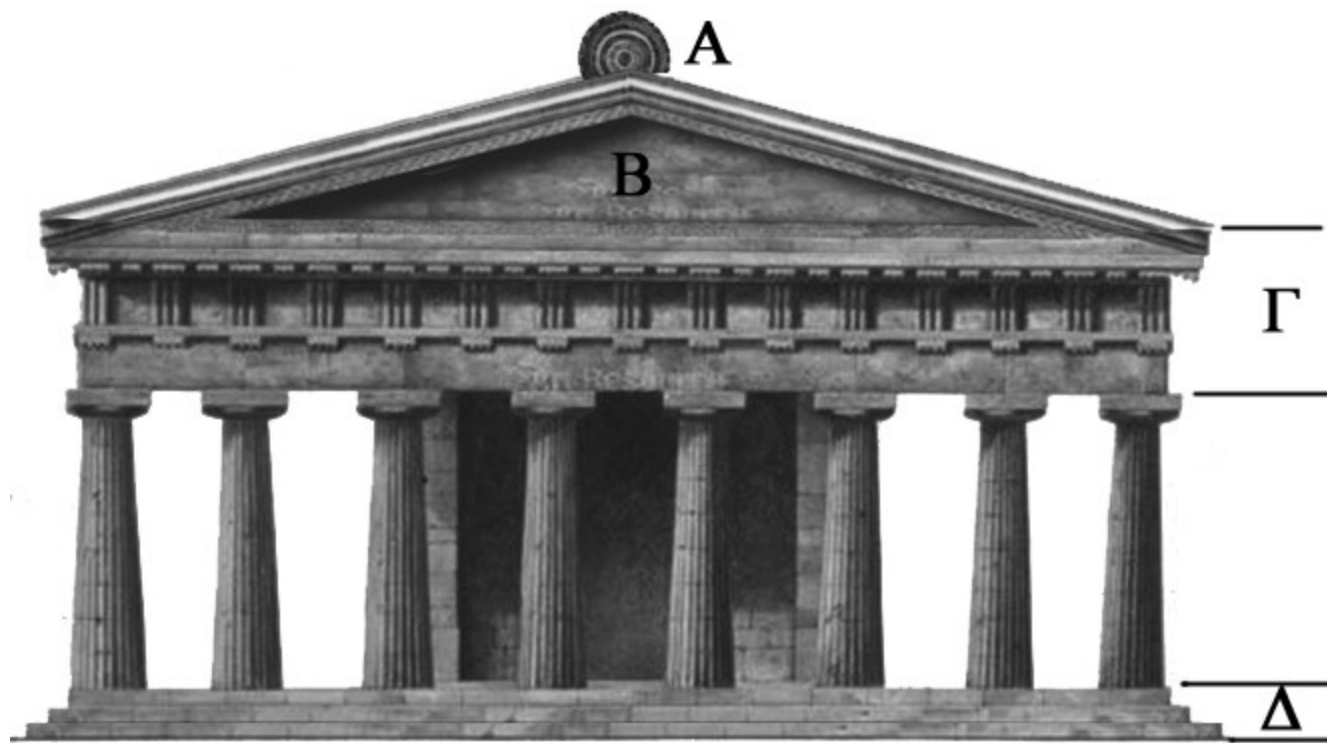

# THE ISSUE OF SCALE

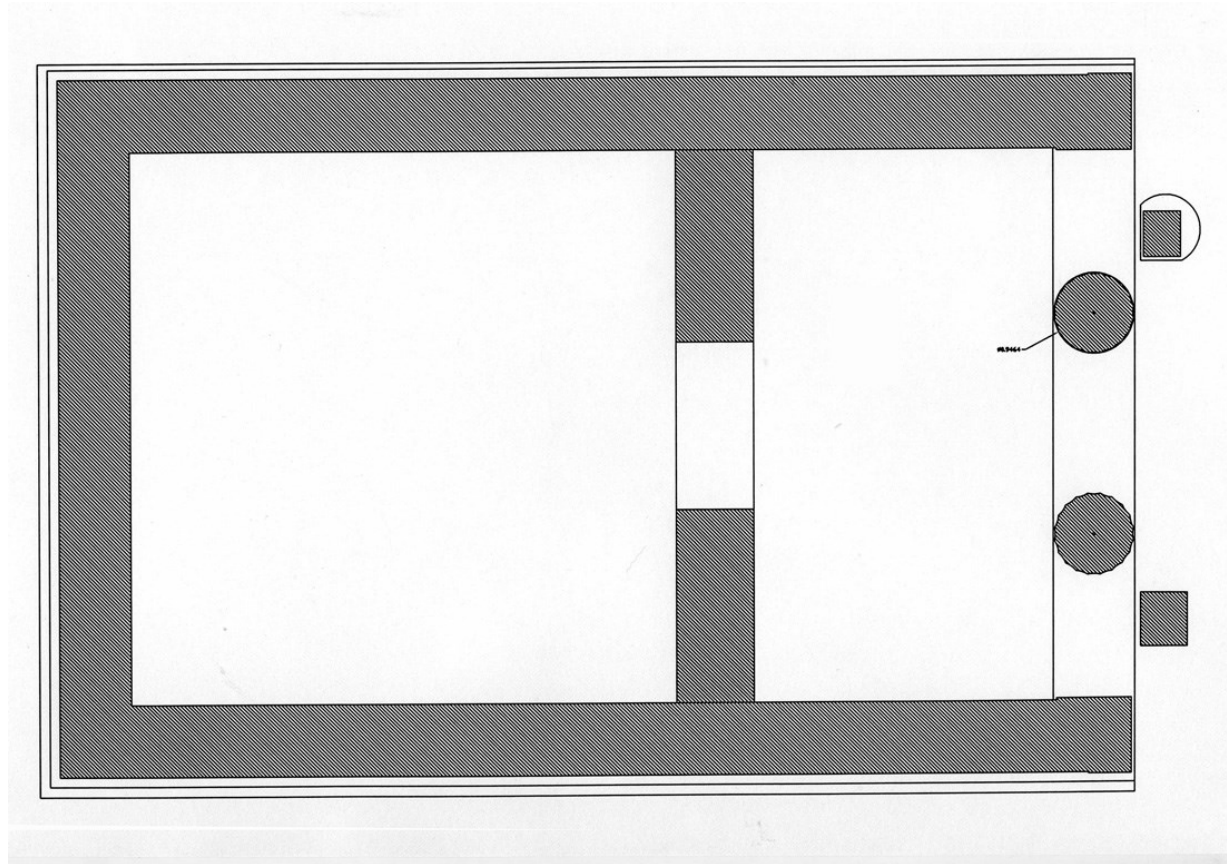

*HEKATOMPOUS*=  
100 FOOT LONG TEMPLE

SHIPS

**PERIPTERAL TEMPLE**

LENGTH  $2v + 1$

6 X 13 COLUMNS

# PELEUS' HOUSE IN THE FRANCOIS VASE

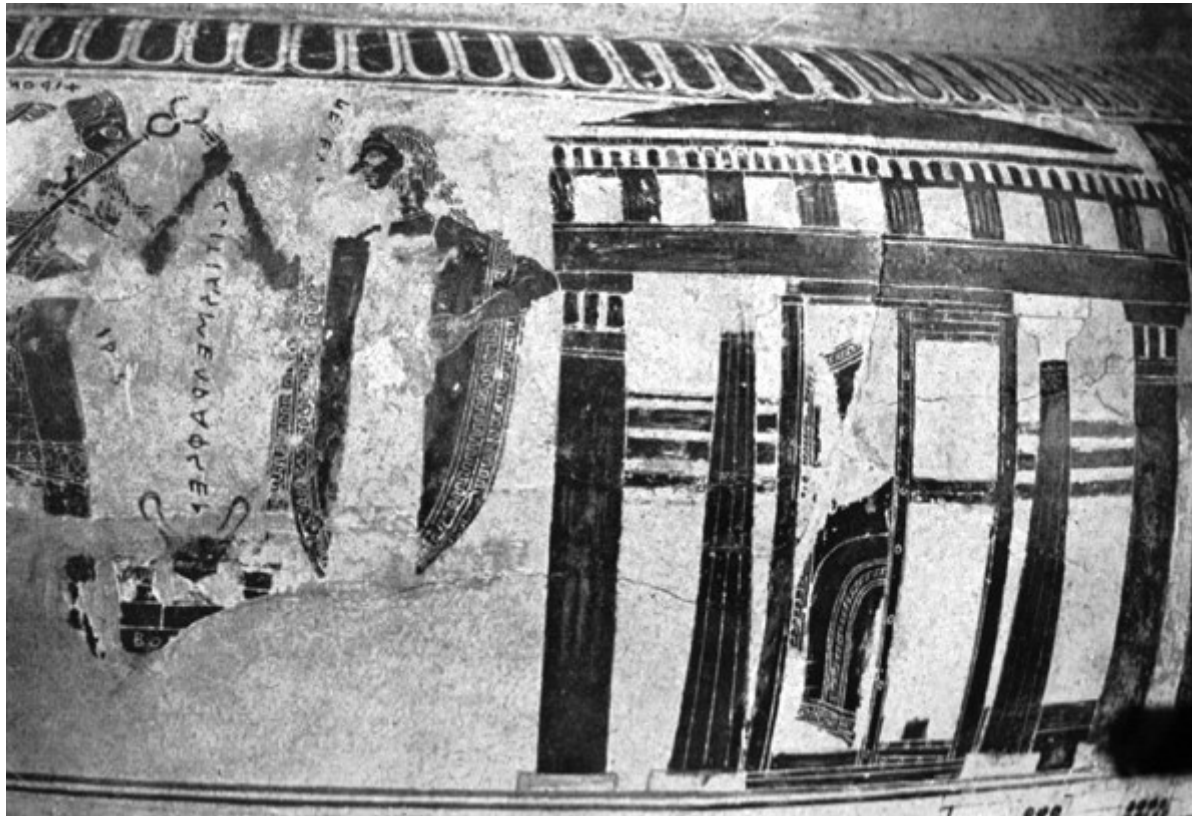

# Temple development Spawforth 2006

Οι χρονολογημένοι  
περίπτεροι ναοί  
ανά περιοχή και ανά αιώνα

αιώνας π.Χ./μ.Χ.	7ος	6ος	5ος	4ος	3ος	2ος	1ος π.Χ.	1ος μ.Χ.	2ος	Σύνολο
Ιταλία/Σικελία	0	20	22	0	1	0	0	0	1	44
Ηπειρωτική Ελλάδα	3	24	22	17	8	1	2	0	2	79
Αιγαίο & Εύξ. Πόντος	1	7	2	1	2	3	0	0	2	18
Μικρά Ασία	1	4	0	6	8	7	8	6	11	51
Συρία & Αφρική	0	0	0	1	3	0	0	0	0	4
Σύνολο	5	55	46	25	22	11	10	6	16	196

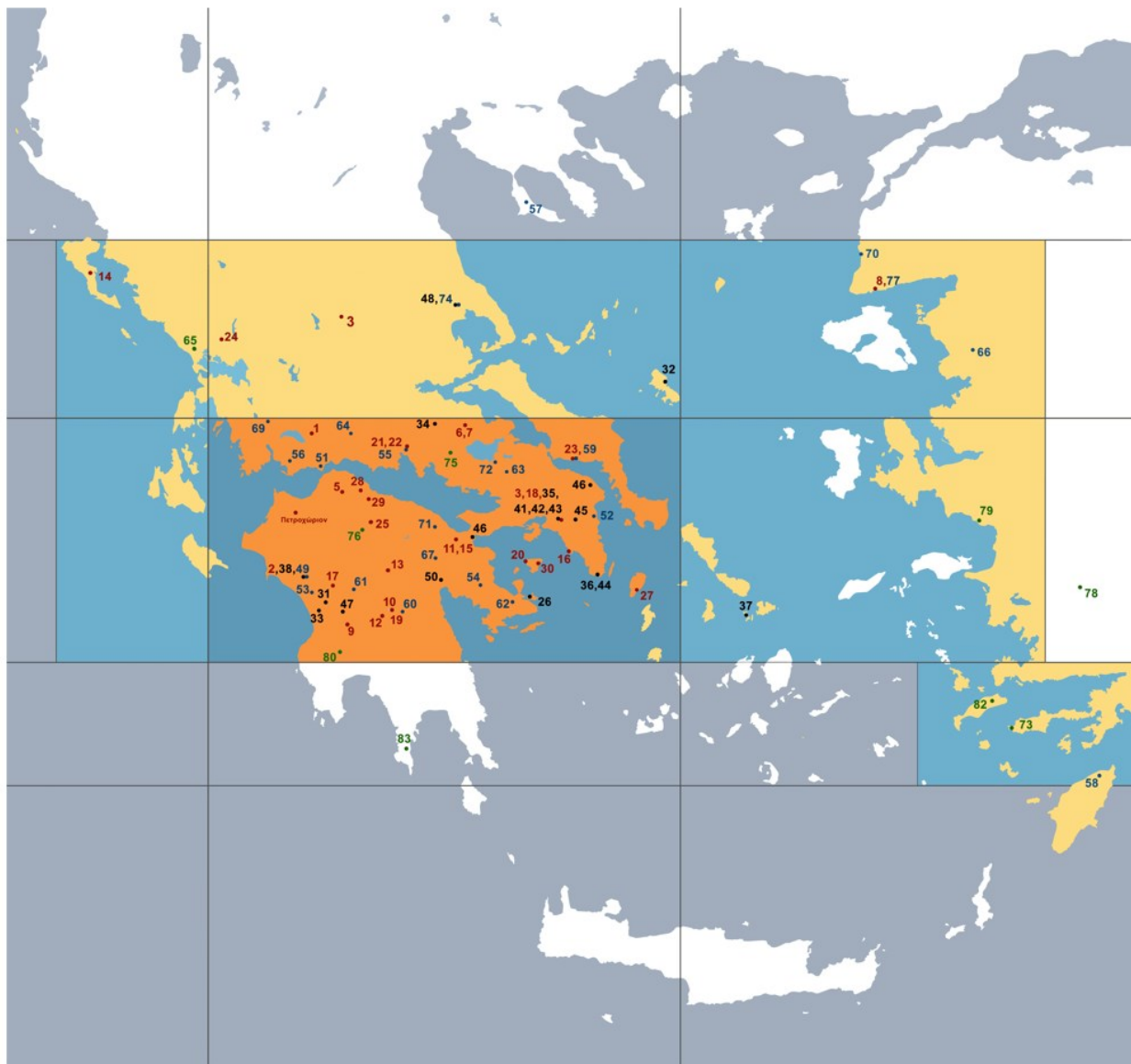

# QUANTITY

- HELLADIC 6<sup>TH</sup>, 5<sup>TH</sup>, 4TH
- DRAMATIC DEVELOPMENT OF TEMPLE ARCHITECTURE IN ASIA MINOR DURING THE 4<sup>TH</sup>-3<sup>RD</sup> C. BC
- ABSENCE OF PERIPTERAL TEMPLES IN THE AEGAN
- NO PERIPTERAL TEMPLE IN MACEDONIA, CRETE, LACONIA!!!

# SANCTUARY OF ARTEMIS, SPARTA, 570 π.Χ.

## *Διαμαστίγωσις*

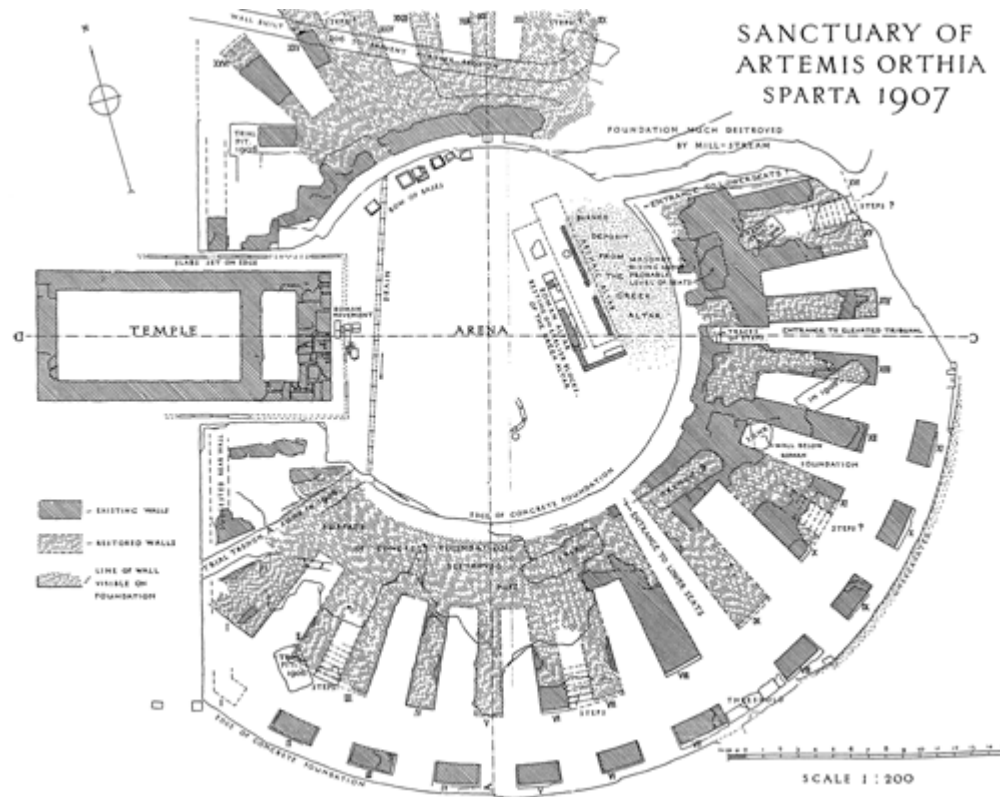



# THE THRONE OF AMYCLAE, SPARTA

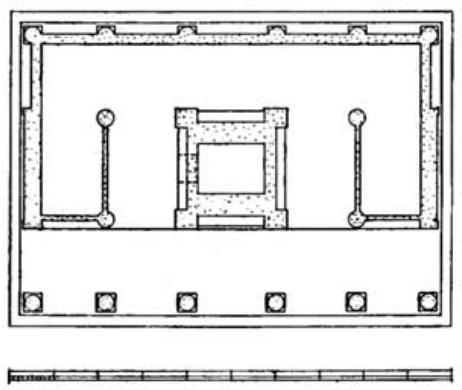
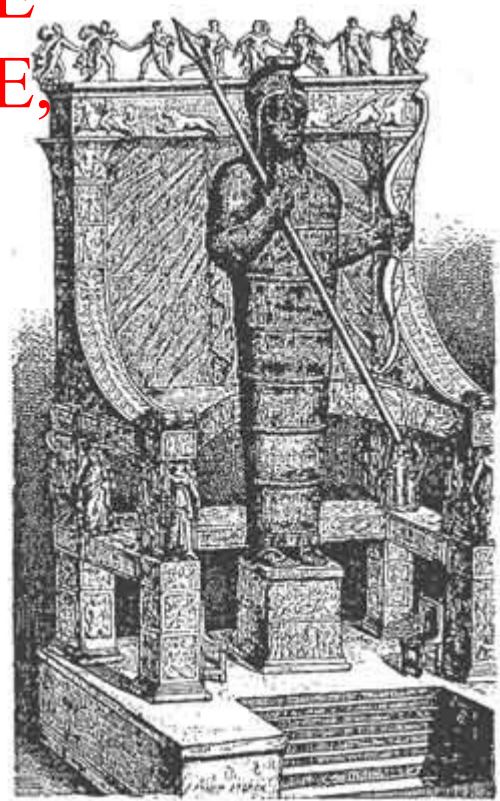
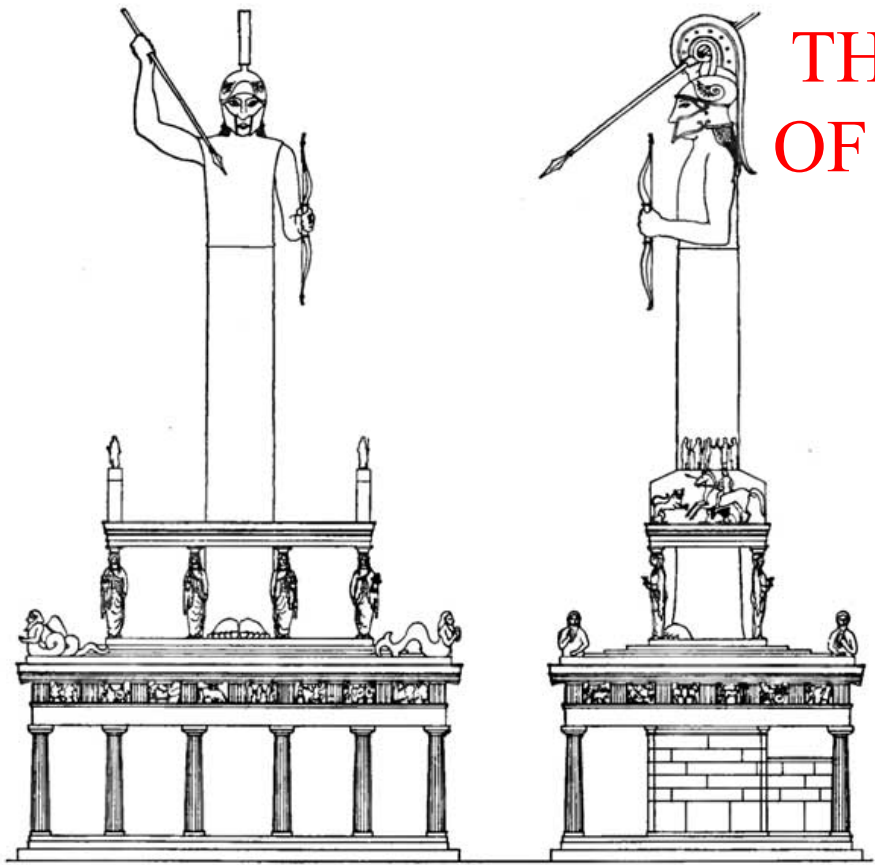

# THRONE AND KINGSHIP IN SPARTA

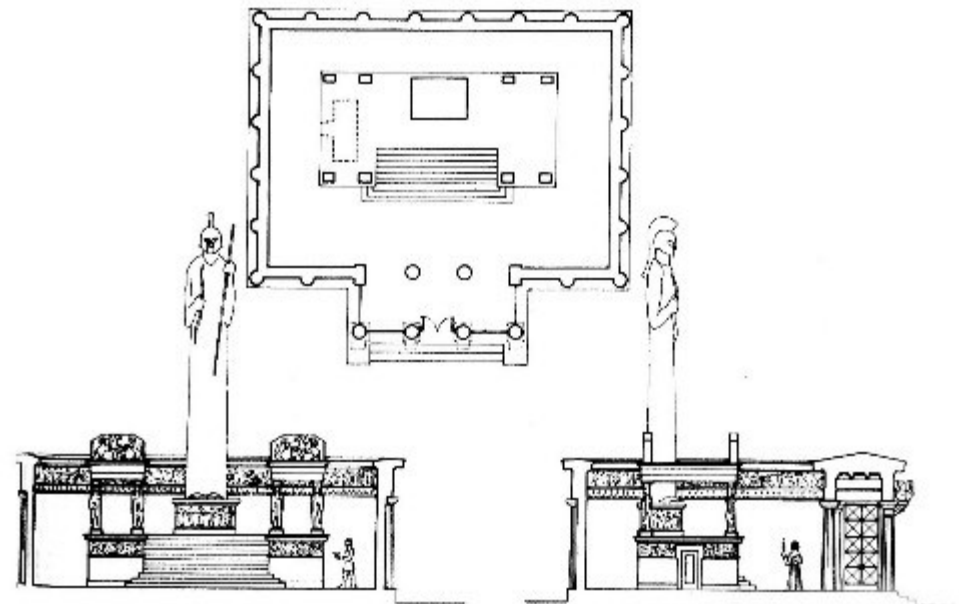
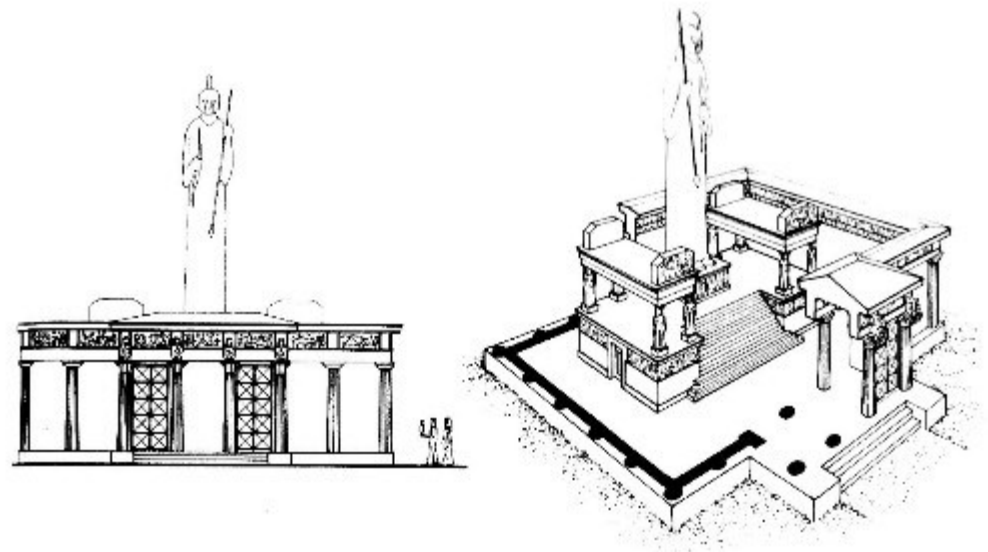

# BATHYCLES, MAGNESIA BY MAEANDER

Πριν το 500 π.Χ.

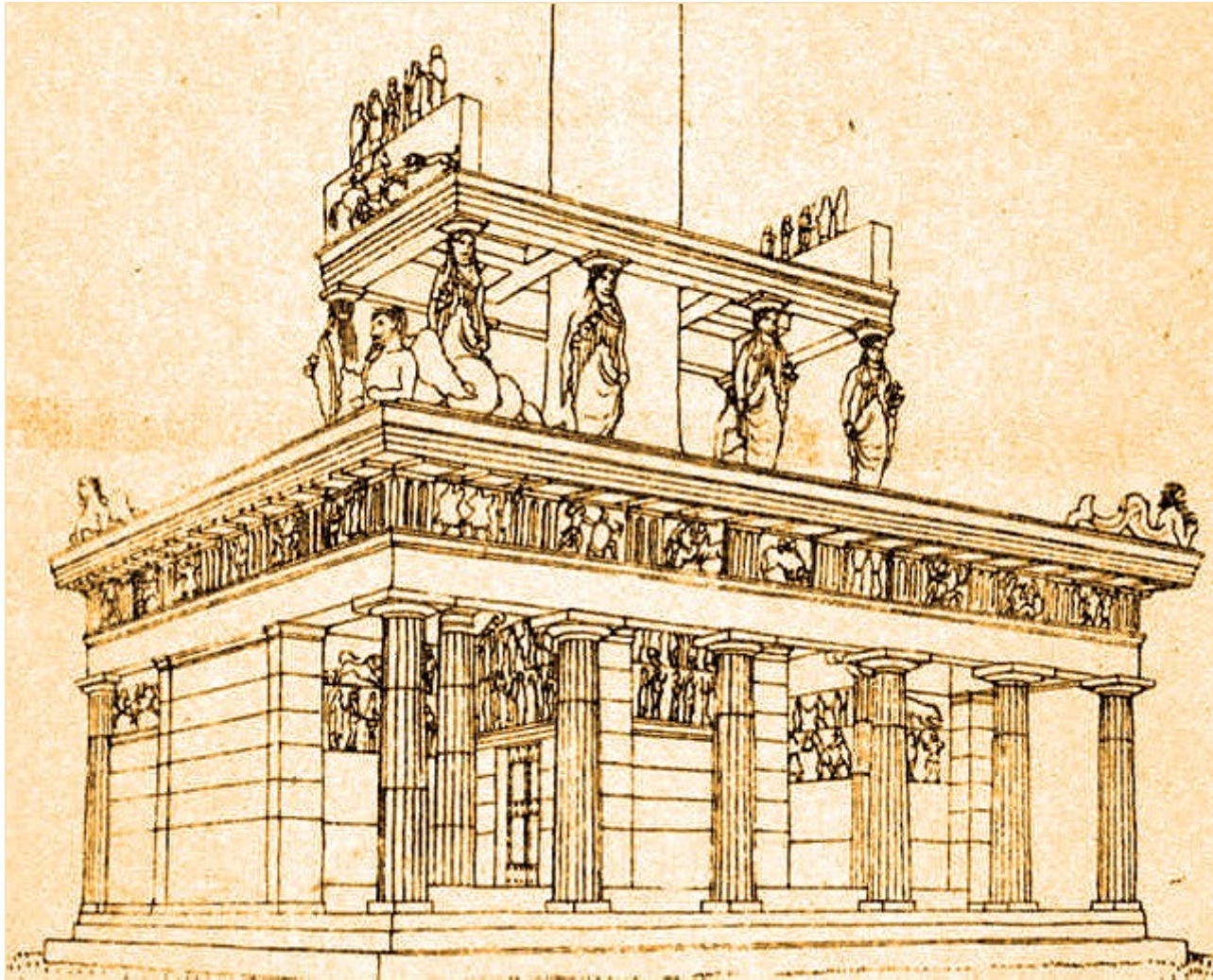



# PHEIDIAS' CONCEPT STATUE OF ZEUS IN OLYMPIA

## 7 WONDERS





# LOCATION AND SYMBOLISM

- A LIGHTHOUSE OF THE COMMUNITY
- THE PERISTASIS / COLUMN CAGE A SPACE OF GATHERINGS OF CITIZENS?
- CONNECTED WITH THE DEVELOPMENT OF CITY STATE.  
(\*SACKS AND ARSONS)
- HALF OF THE TEMPLES ARE IN RURAL LANDSCAPES
- “METROPOLITAN” CITY TEMPLES

# SIZE

- UNIFINISHED ARCHAIC COLOSSAL TEMPLES
- THE ANTAGONISM OF THE TYRRANTS
- MANY TEMPLES CLUSTERED TOGETHER IN ITALY
- TWO TEMPLES ON THE ACROPOLIS?
- «EVERY NEW TEMPLE IS LARGER THAN ITS PREDECESSOR»



# SAMOS. THE TYRRANTS

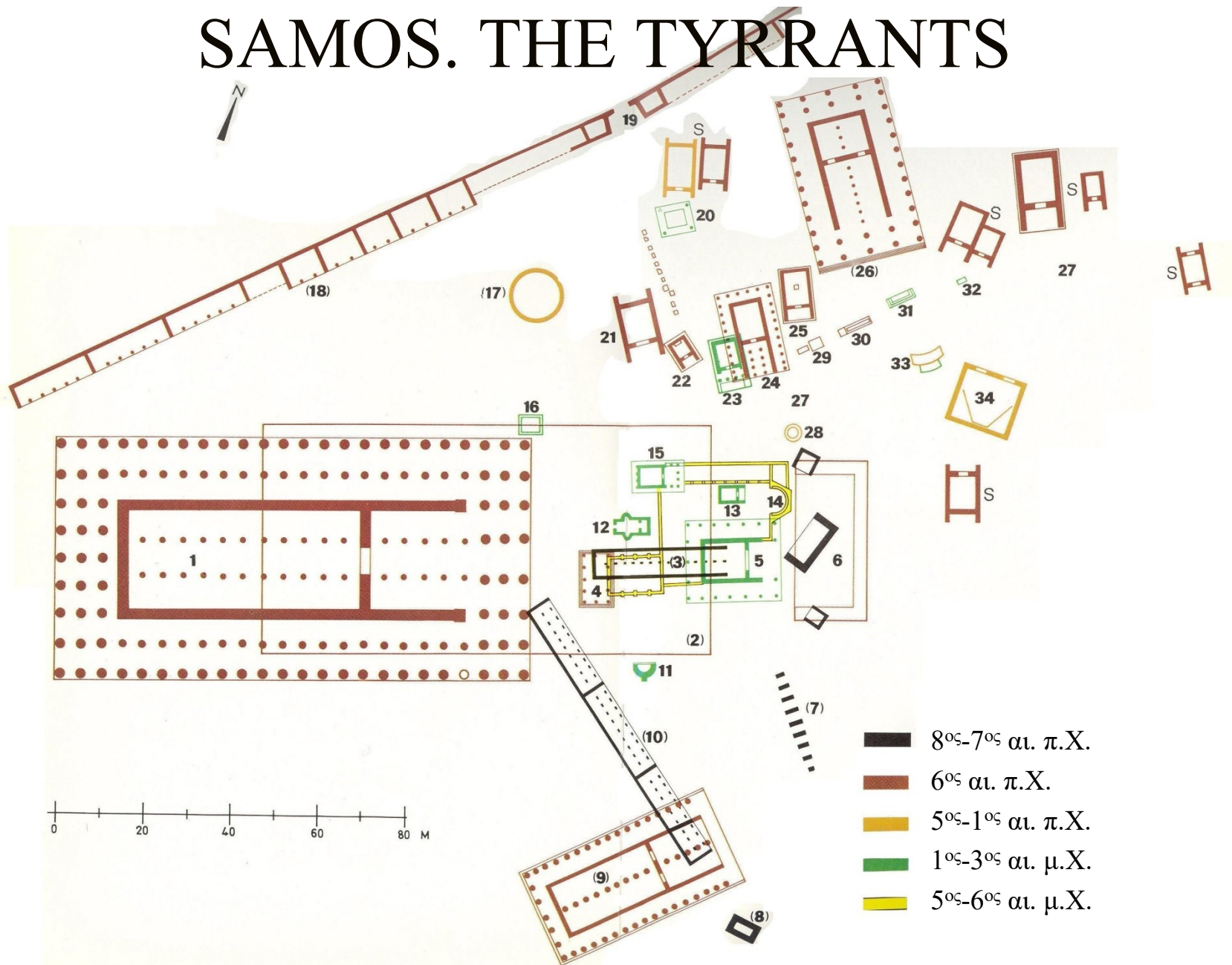

# ITALY AND SICILY



© 2007 Europa Technologies  
Image © 2007 DigitalGlobe

© 2007 Google™

Pointer lat 40.422001° lon 15.005348° elev 50 ft

Streaming ||||| 100%

Eye alt 2452 ft



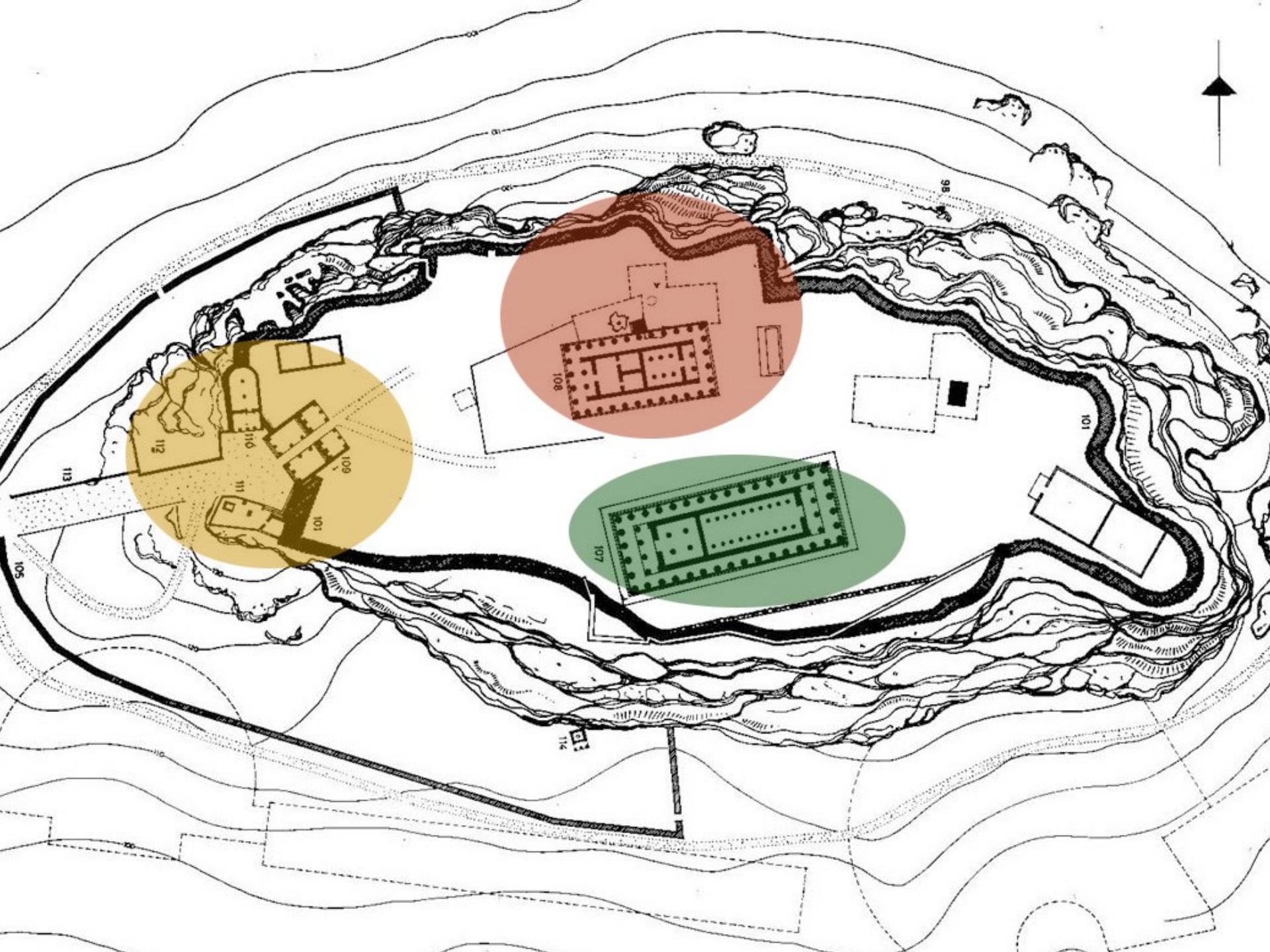

# PORTARA ON NAXOS. TYRRANT LYGDAMIS



# OLYMPIAN ZEUS, ATHENS



... ABANDONED DURING DEMOCRACY



5<sup>TH</sup> CENTURY BC. ATHENS

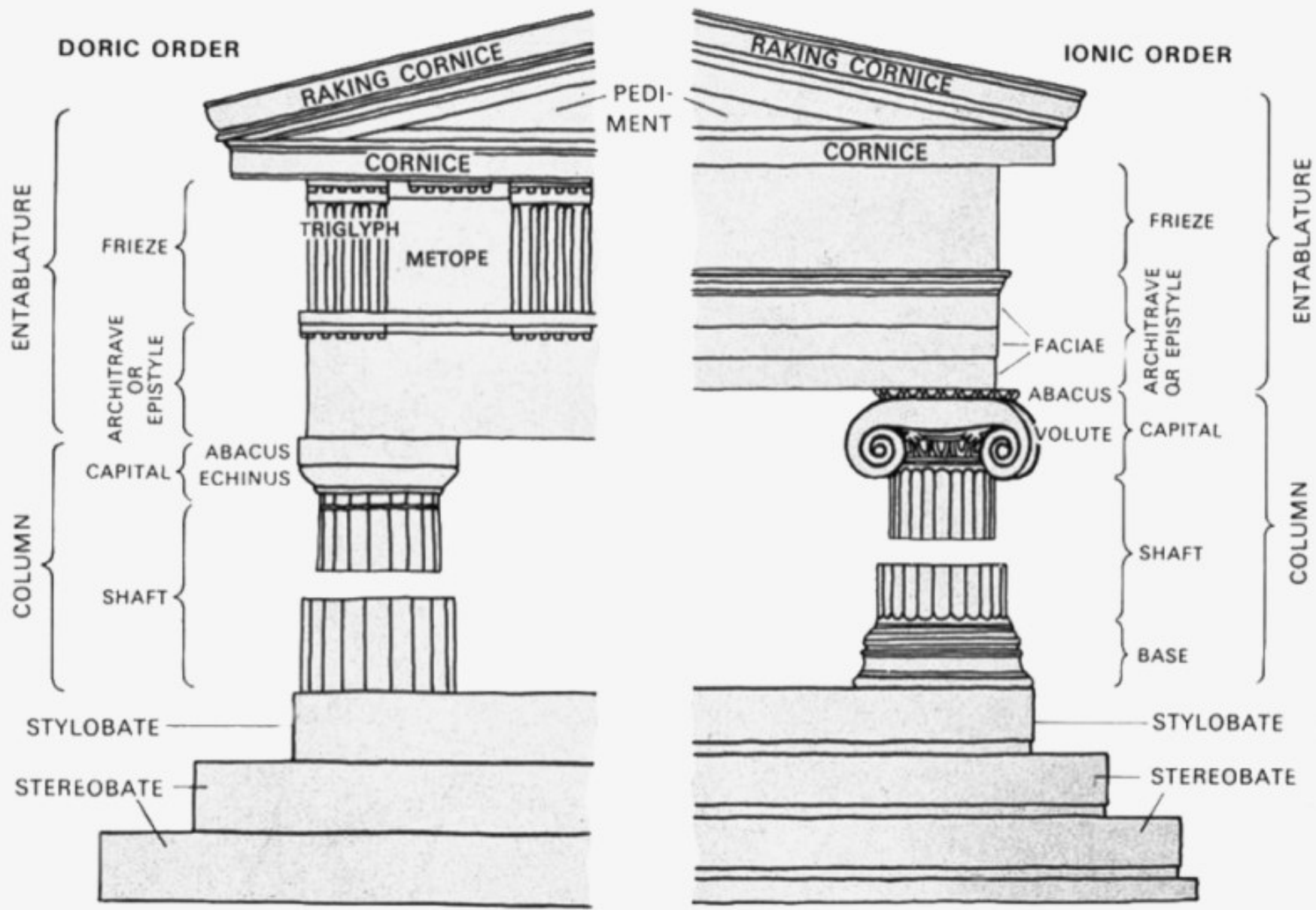



# KREPIS

- STYLOBATE
- RAMPS IN THE PELOPONNESE



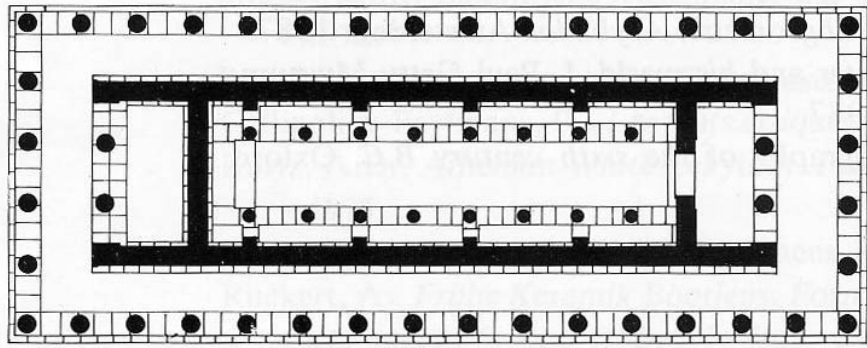

39. Κάτοψη αρχαίου Ηραίου Ολυμπίας.  
Γύρω στο 600 π.Χ.

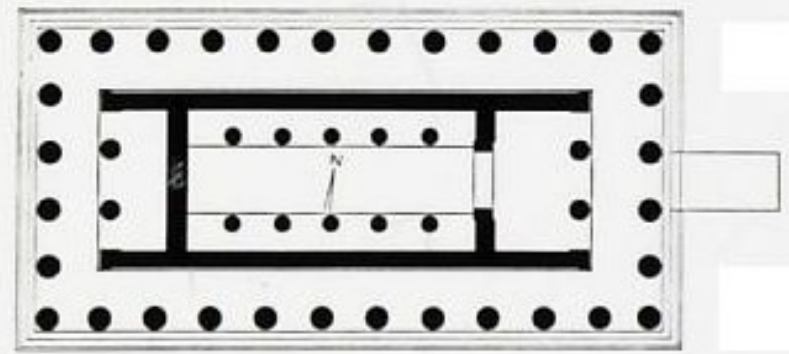

0 5 10 15 20 M

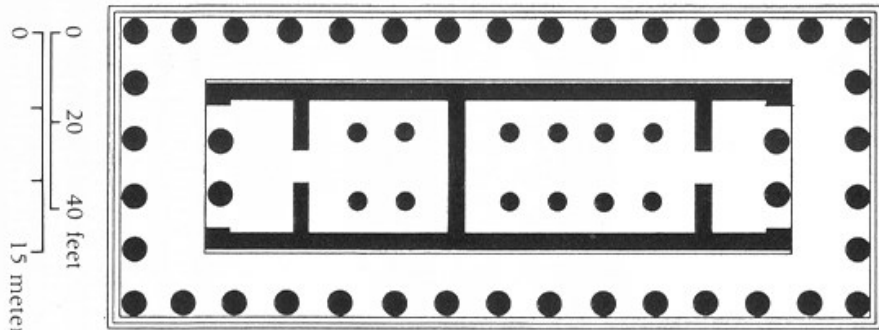

0 0 20 40 feet 15 meters

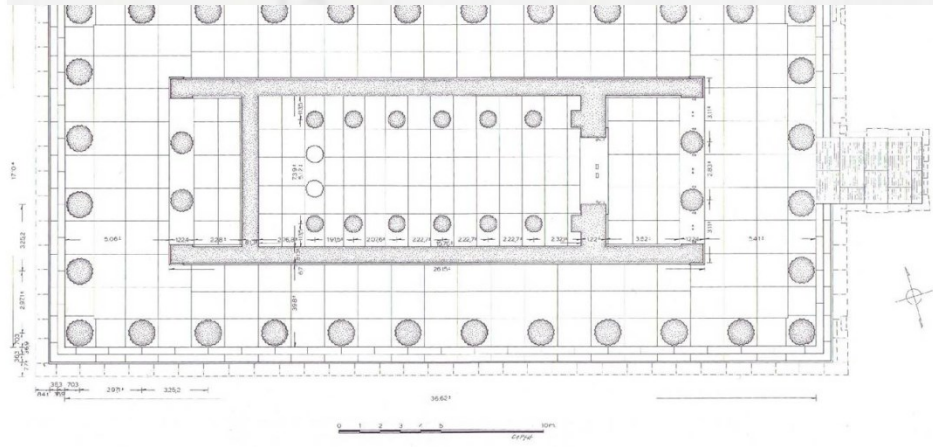

0 1 2 3 4 5 6 7 8 9 10 meters

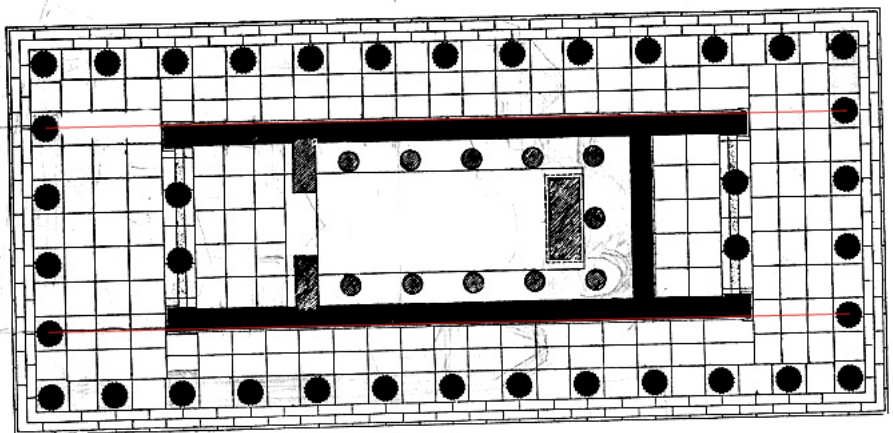
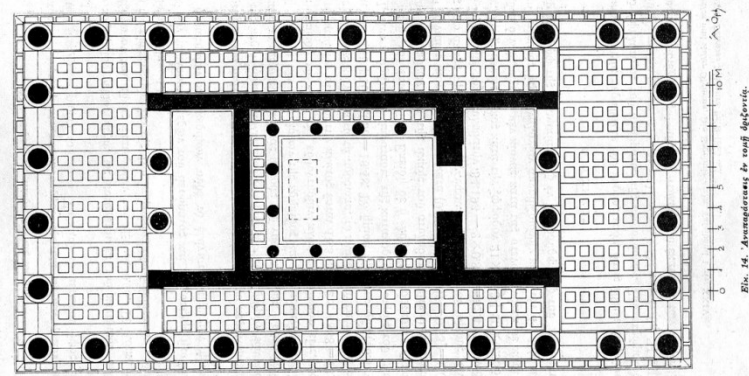

Fig. 67.—THE HERAEUM. (Restored by Dinsmoor.)



0 5 10 15 20 μέτρα περί του ναού

INTERIOR COLONNADES

- INTERAXIAL COLUMN SPACING =  
DISTANCE BETWEEN AXES OF  
COLUMNS
- INTERCOLUMNIUM = CLEAR SPACE  
BETWEEN COLUMNS

# THE DORIC COLUMNS

- NO BASE
- OVERALL HEIGHT = 5.6 – 7 TIMES THE LOWER DIAMETER
- FLUTES WITH SHARP EDGES BETWEEN THEM
- 20 FLUTES
- ENTASIS = BULGING OF THE SHAFT

# ENTASIS





© 2003 QT Luong / terragalleria.com

# ita17465



# West Facade



© 2003 The Museum of Reconstructions, Inc.

# Overall View



© 2003 The Museum of Reconstructions, Inc.



# DORIC CAPITAL

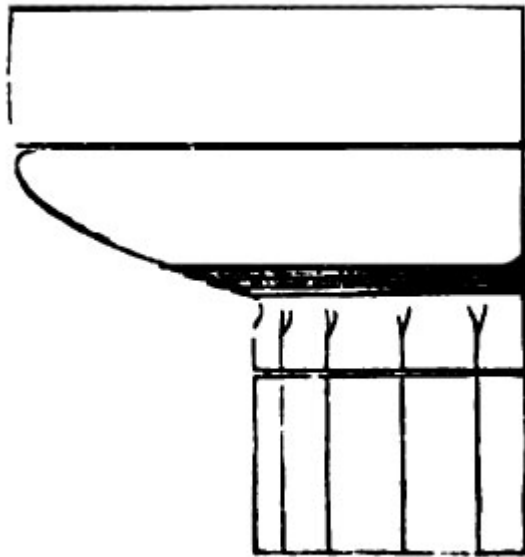

Bible History Online

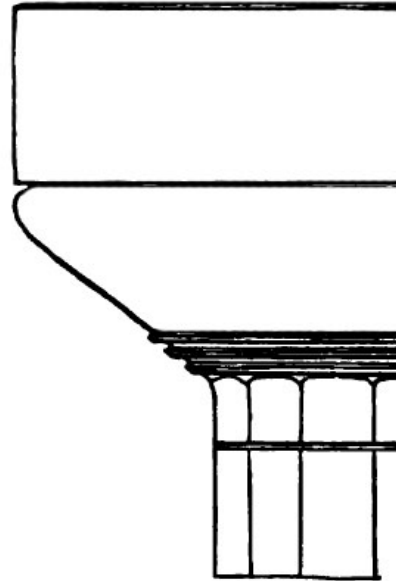

Bible History Online

# TRIGLYPH - METOPE REGULAE - PEGS



# THE TRIGLYPH AND THE RHYTHM

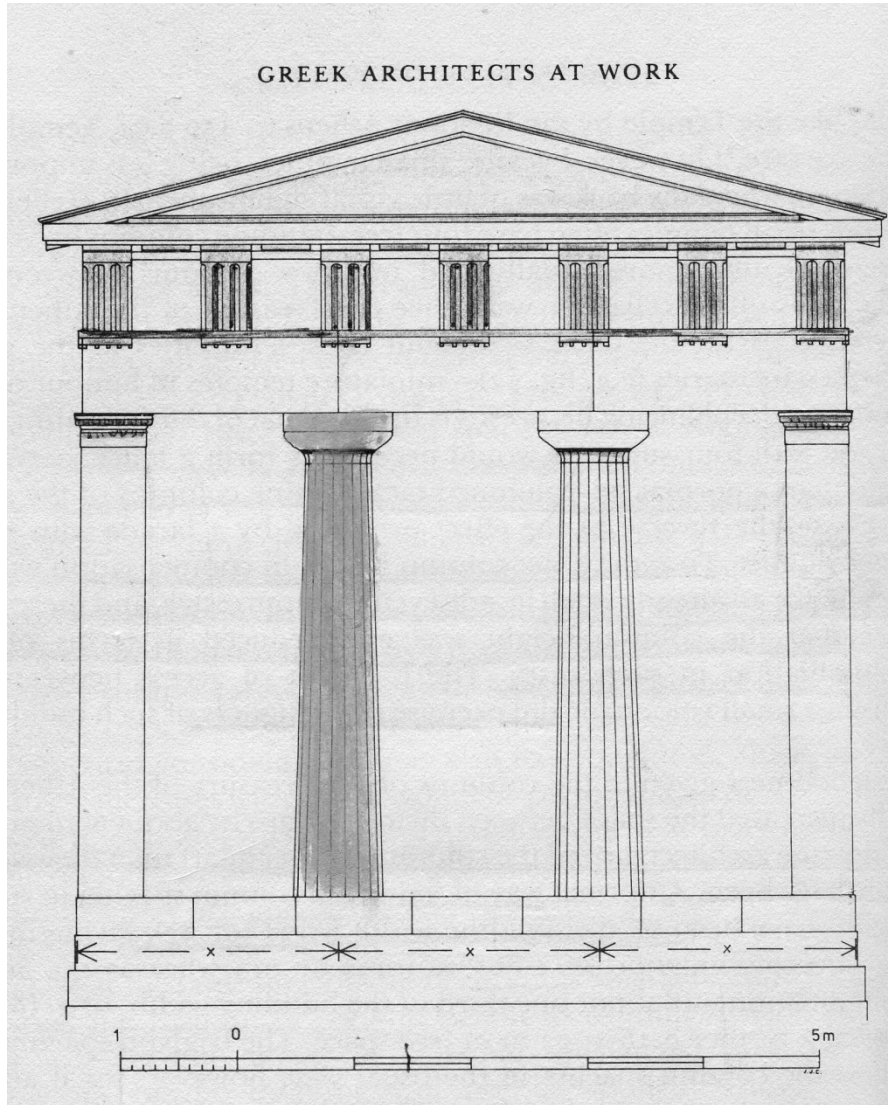

# 3 TRIGLYPHS OVER AN INTERAXIAL SPACING



## STOA AT BRAURON, 420 Π.Χ.



# TEMPLE OF ZEUS, OLYMPIA

## ΠΡΟΝΑΟΣ

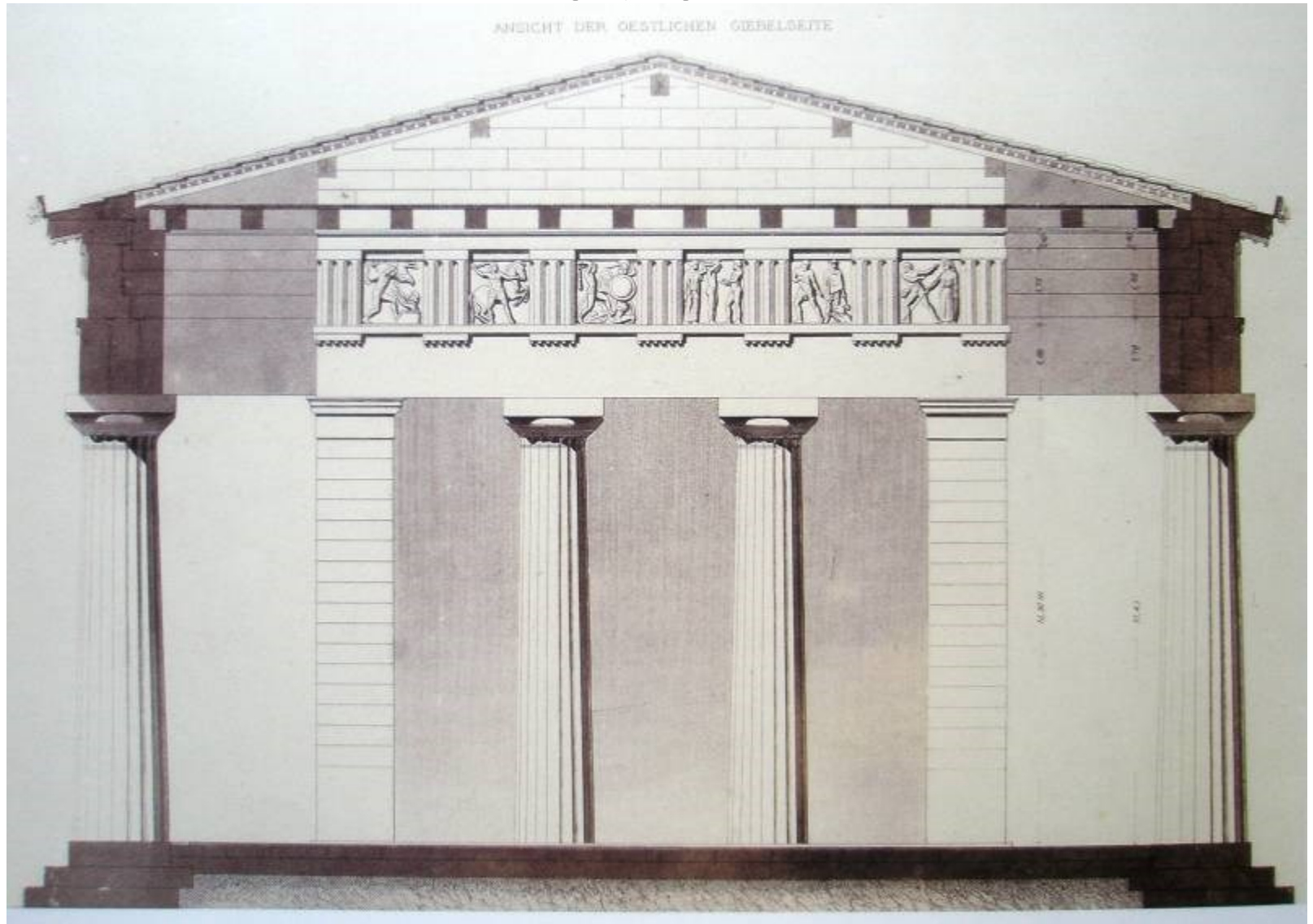

# RELIEF METOPES TEMPLE OF HEPHAISTOS, ATHENS







A

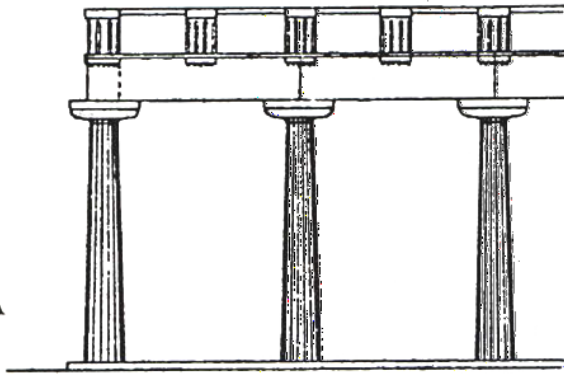

B

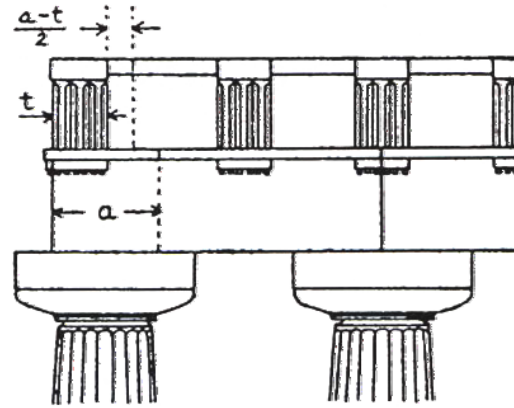

Γ

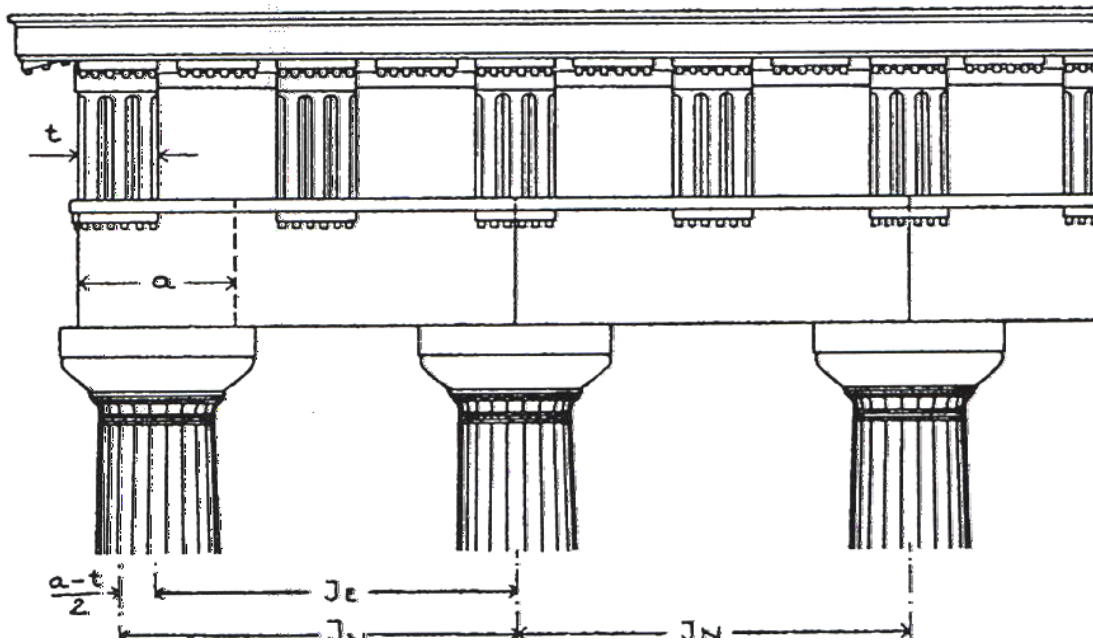

προσπάθειες **λύσης** του  
 προβλήματος του  
 γωνιαίου μεταξονίου  
 στους δωρικούς κίονες  
 (δύο τελευταία προς τις  
 γωνίες μετακίονια  
 διαστήματα μικρότερα)

# Η ΓΩΝΙΑΚΗ ΣΥΝΑΙΡΕΣΗ

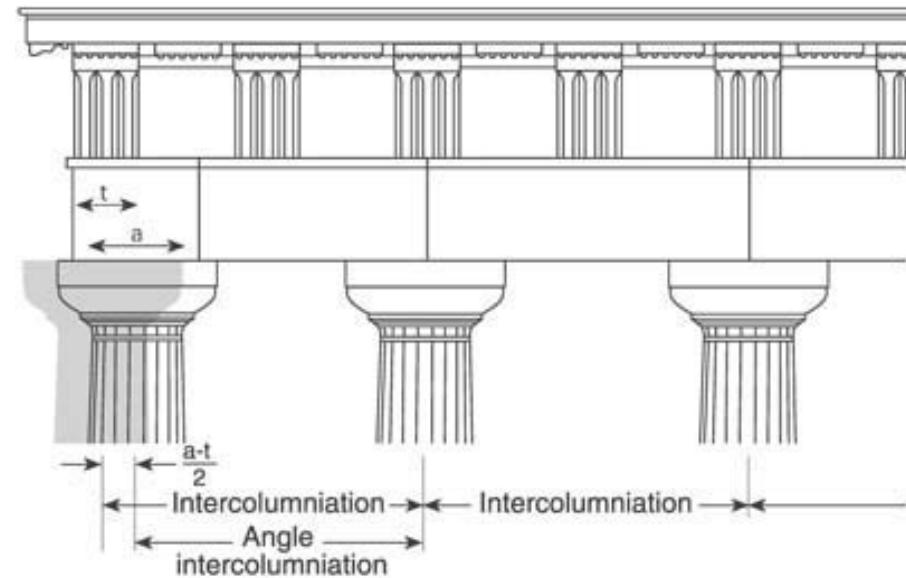
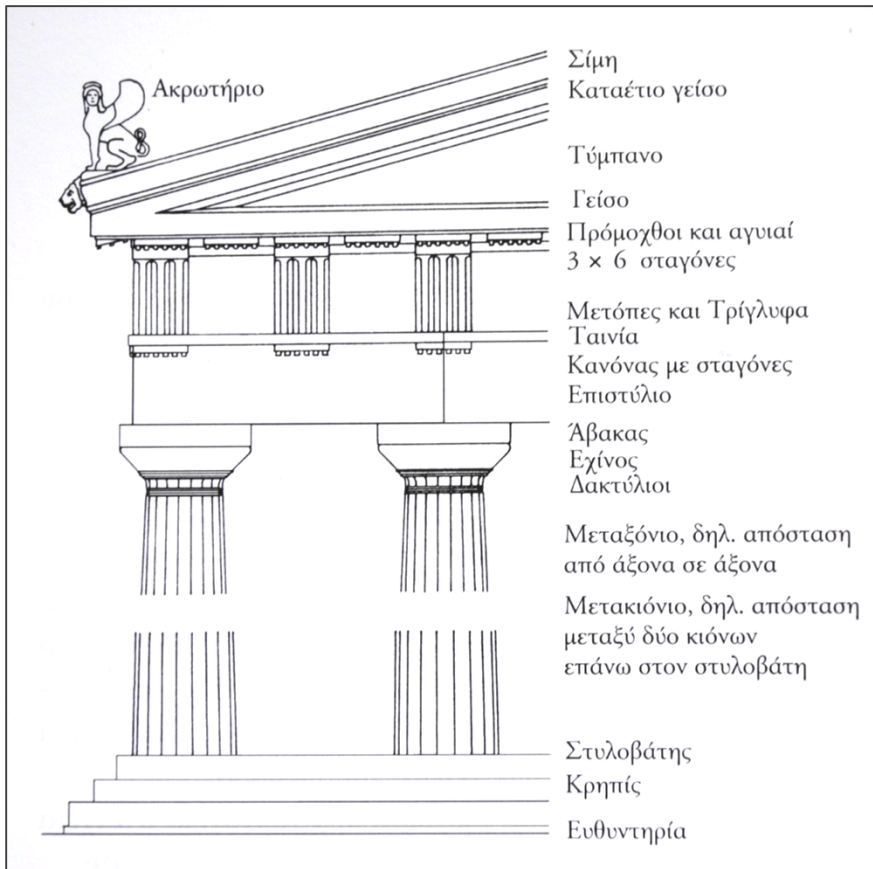



# CEILINGS

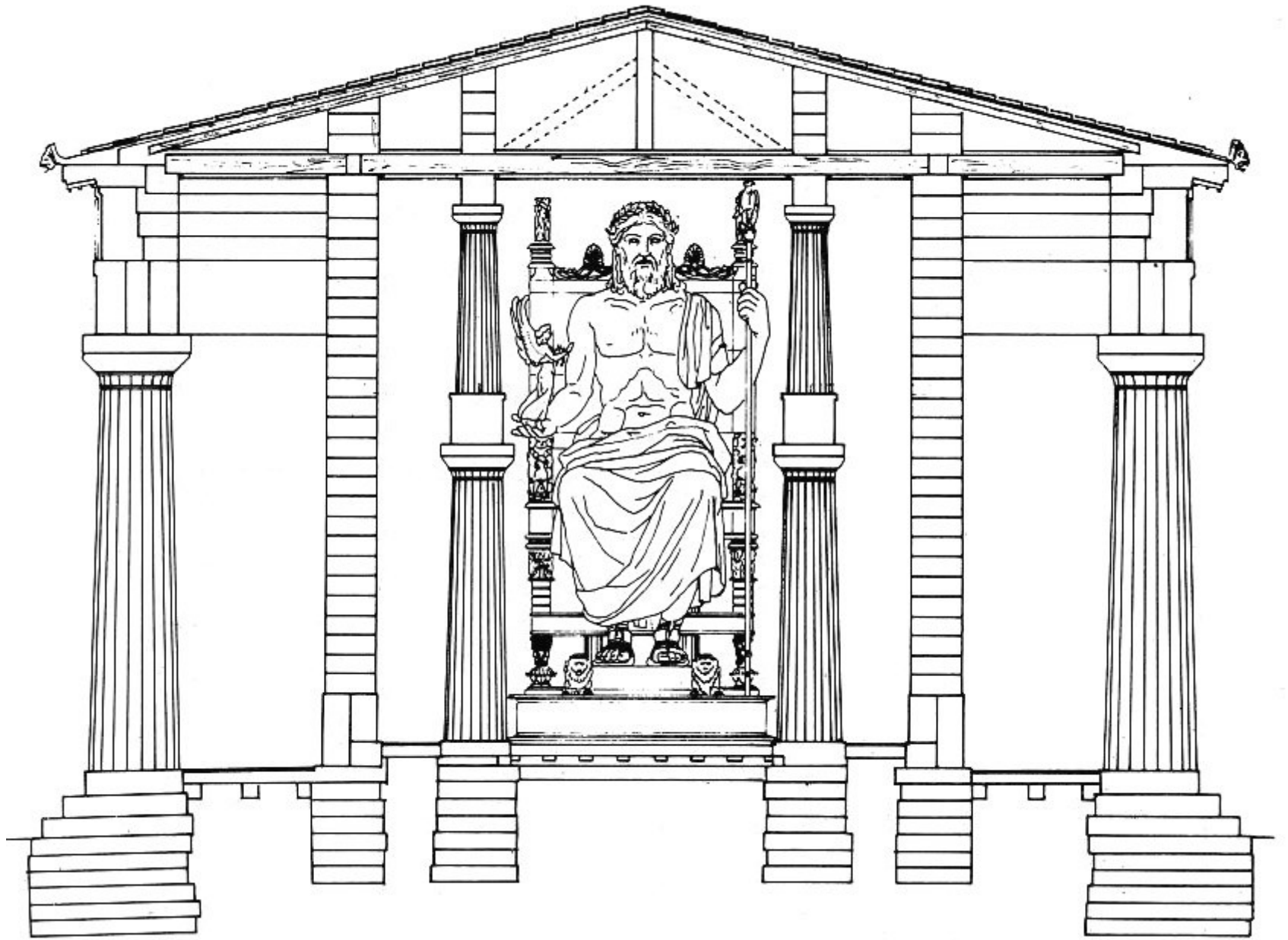

# ΠΑΡΘΕΝΩΝ

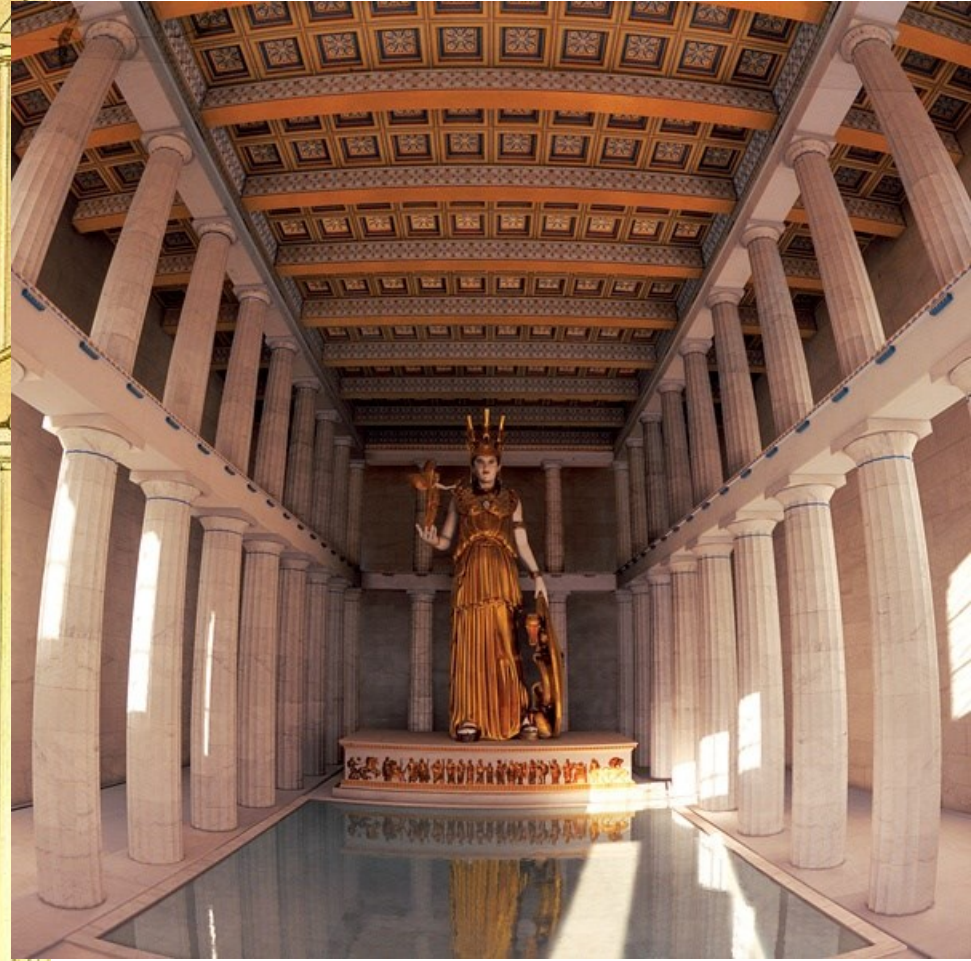
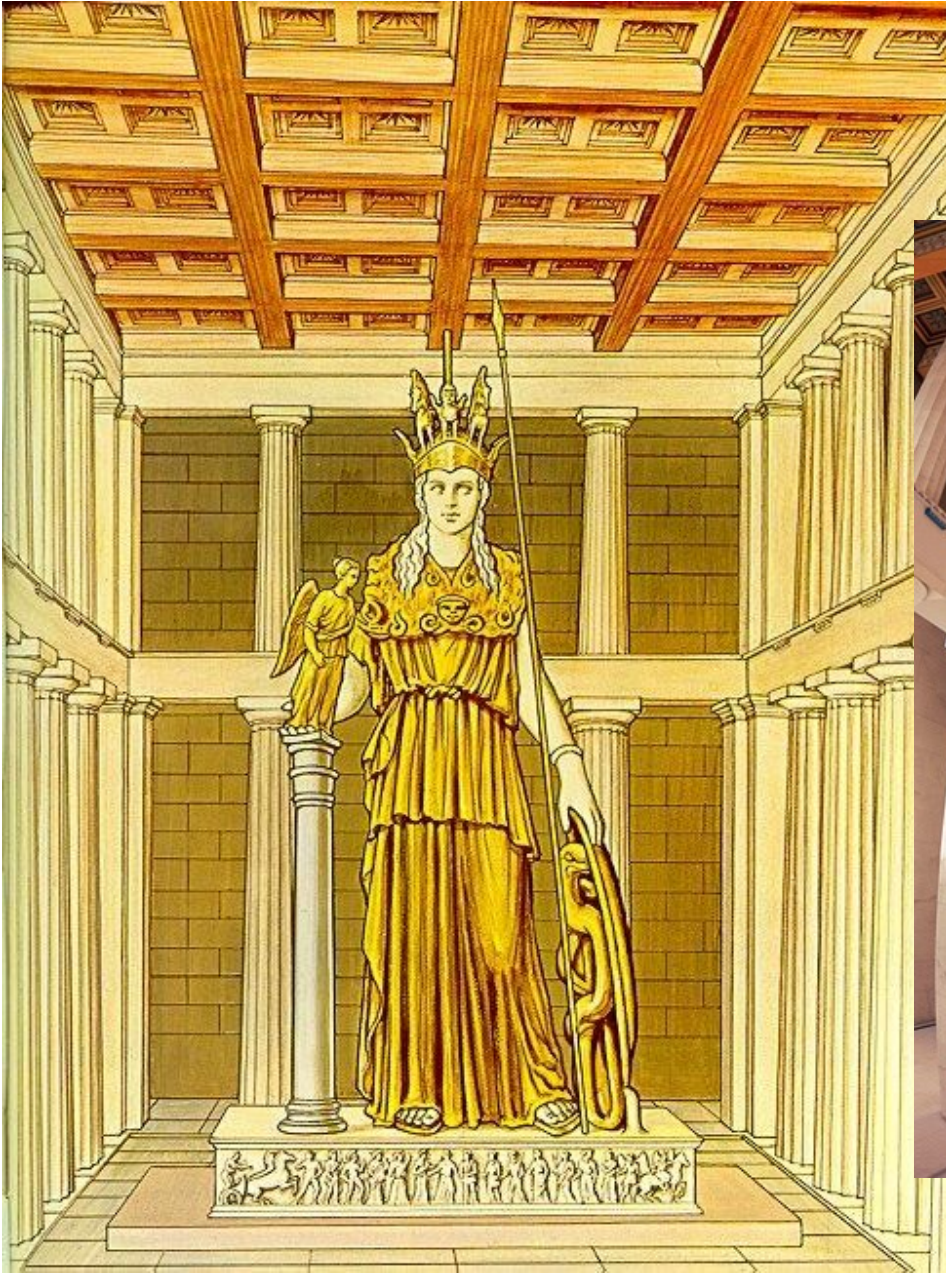











©2001 Brandon Cline







# ΩΡΙΜΗ ΚΛΑΣΙΚΗ ΠΕΡΙΟΔΟΣ 450-400 Π.Χ. ΑΘΗΝΩΝ

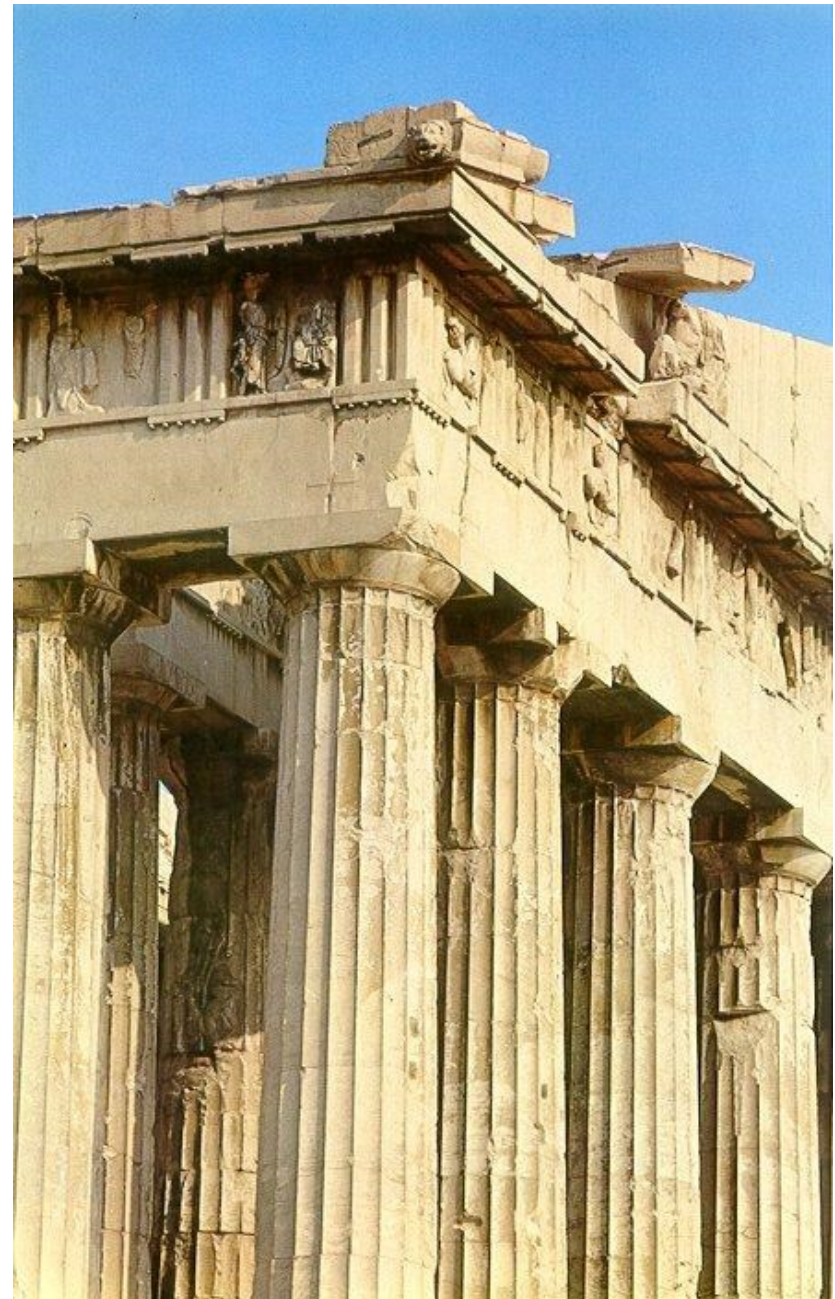
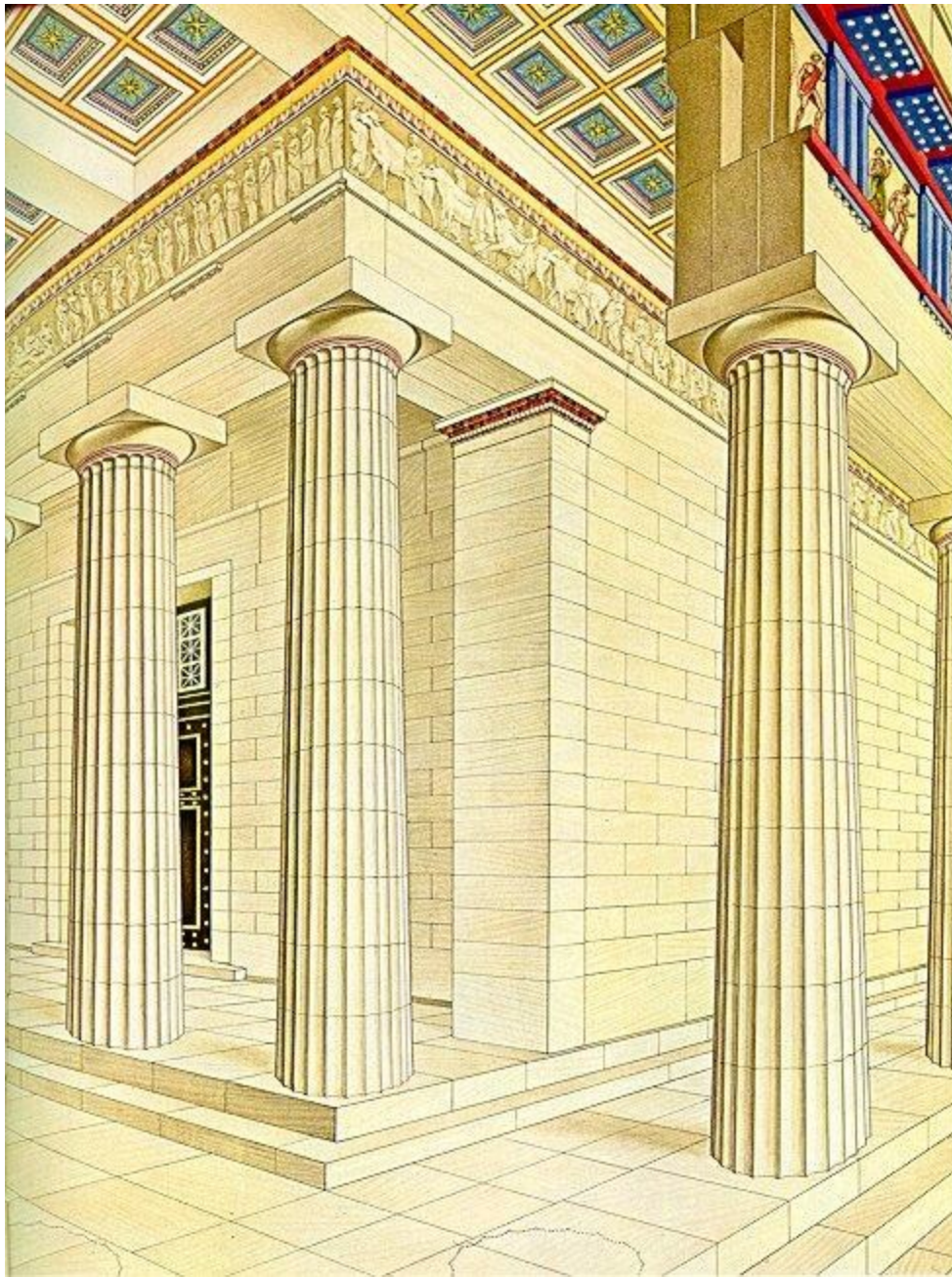

# COLORS 450-400 π.Χ.

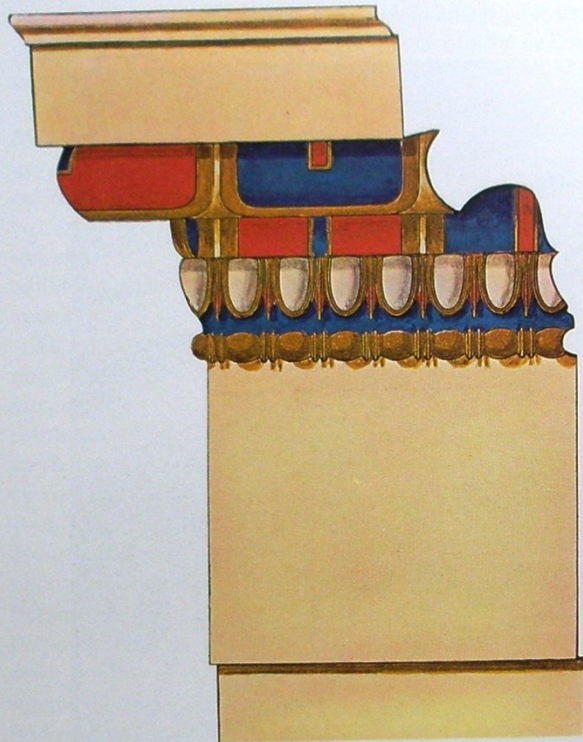

Φάτνωμα

Ἐπίκρανον τῆς παραστάδος: τὰ χρώματα τοῦ στέφανου δωρικοῦ κυματίου καὶ τοῦ ὑπ' αὐτὸ κανόνος τῶν ὀδῶν μετὰ τοῦ σχετικοῦ χρυσοῦ ἀστραγάλου.



Τὰ χρυσὰ ἀνθήματα τῆς σίμης καὶ ἀποκατάστασις τοῦ ἐγχρώμου ἐκ καρδιοσχημῶν φύλλων κυματίου τοῦ κατωτέρου καὶ τῶν γεωμετρικῶν τοῦ ὀριζοντίου γείσου.



\*Ἐγχρωμος ἀποκατάστασις τοῦ διπλοῦ μαιάνδρου καὶ τῶν κυματίων (δωρικοῦ καὶ λεσβίου) τοῦ θράνου τοῦ πτεροῦ.



Τὰ χρυσὰ κοσμήματα (μαιάνδρος καὶ ἀνθήματα) τῆς ταινίας καὶ τοῦ κανόνος τοῦ ἐπιστυλίου.





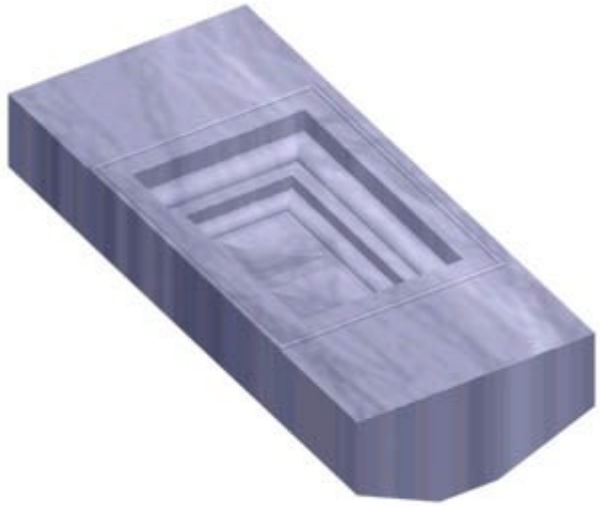





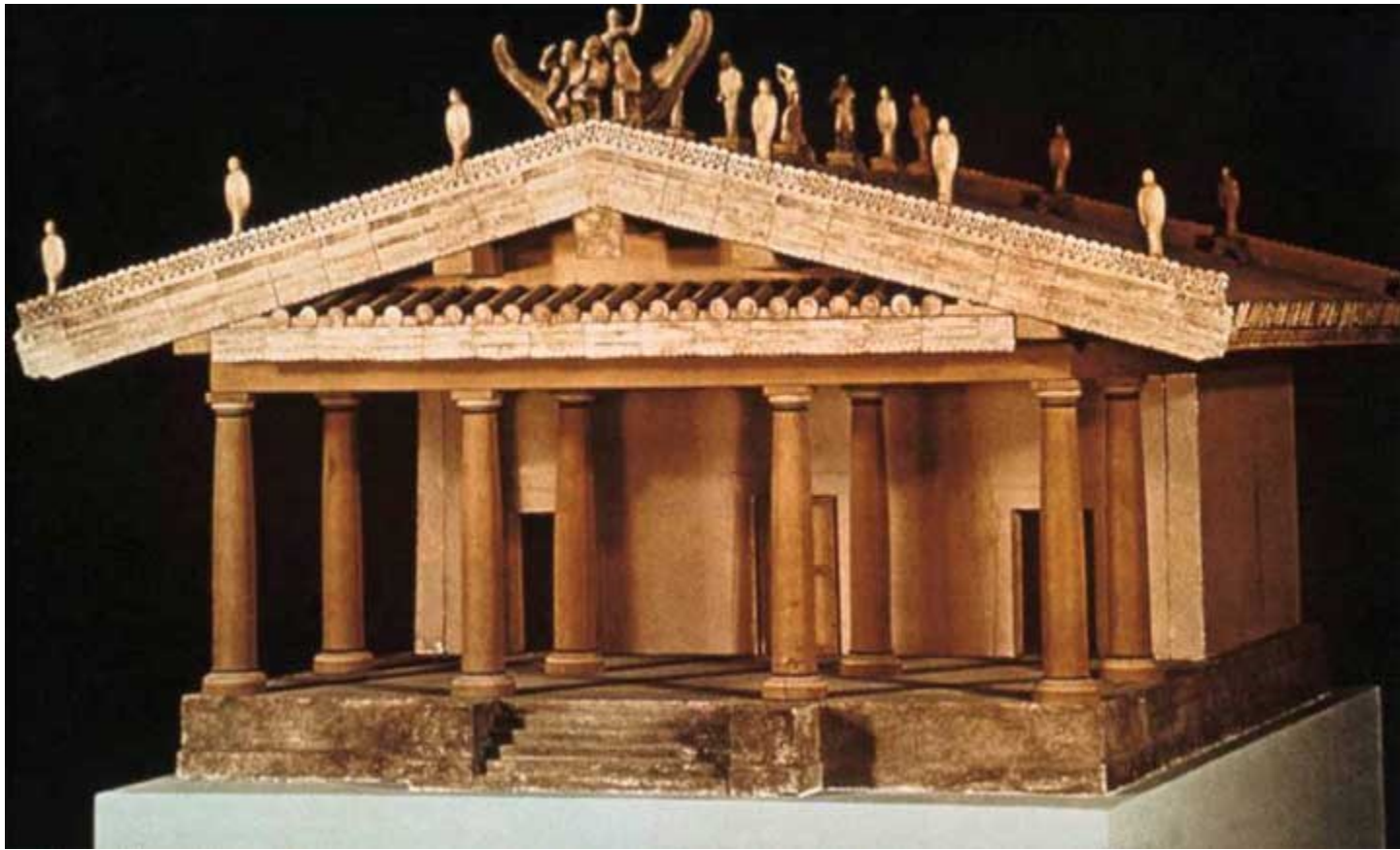







# THE PEDIMENT. RELIGIOUS ARCHITECTURE



πήλινος υστερογεωμετρικός οικίσκος από  
το Ηραίο της Περαχώρας  
(μέσα 8<sup>ου</sup> αι. π.Χ.)

5/11/2024



πήλινος αναθηματικός οικίσκος από  
το Ηραίο του Άργους (τέλη  
8ου αι. π.Χ.)

72



πήλινος αναθηματικός  
οικίσκος από το Ηραίο  
του Άργους (τέλος  
8ου αι. π.Χ.)

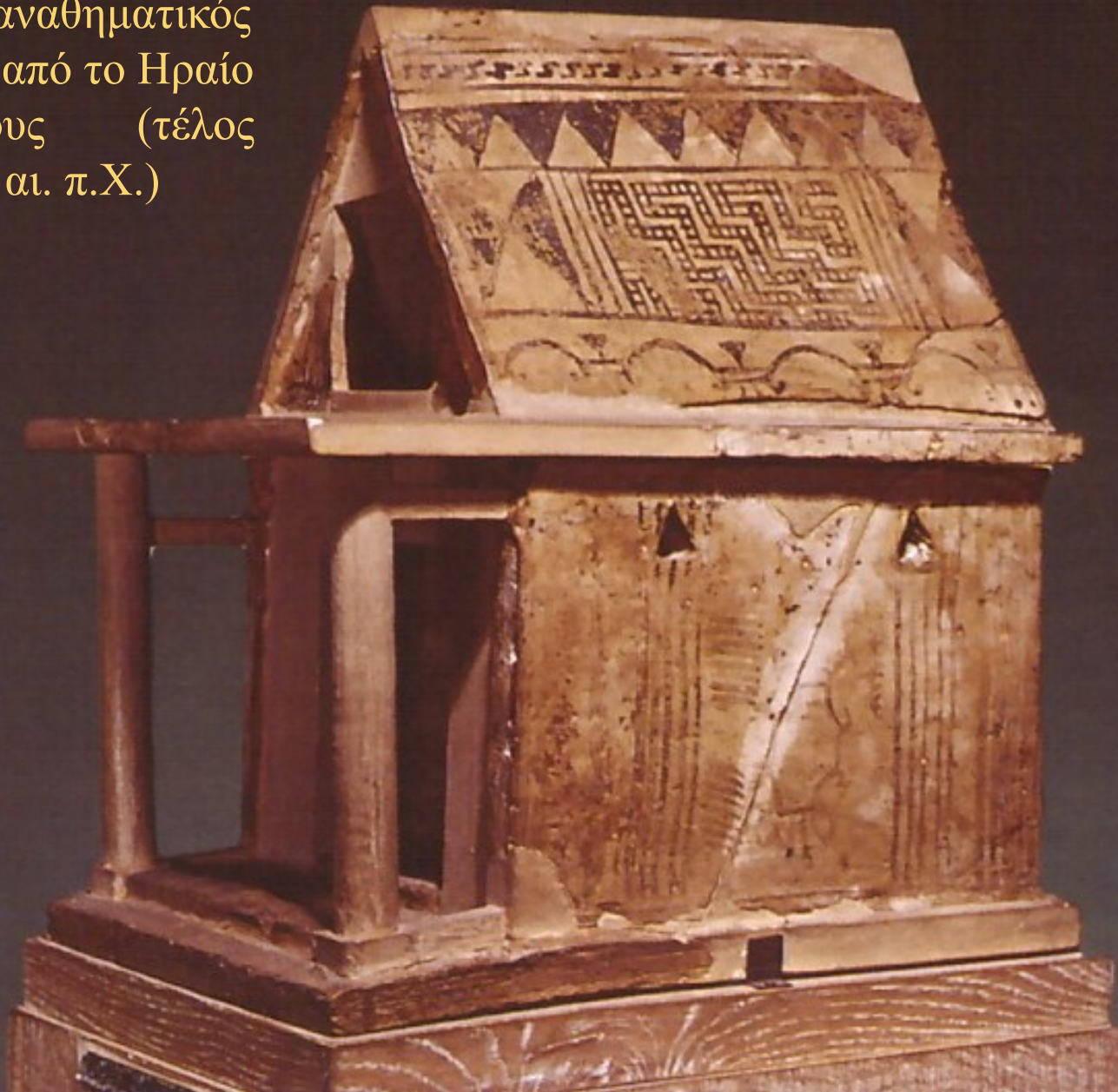

## ΟΜΟΙΩΜΑΤΑ ΟΙΚΙΩΝ

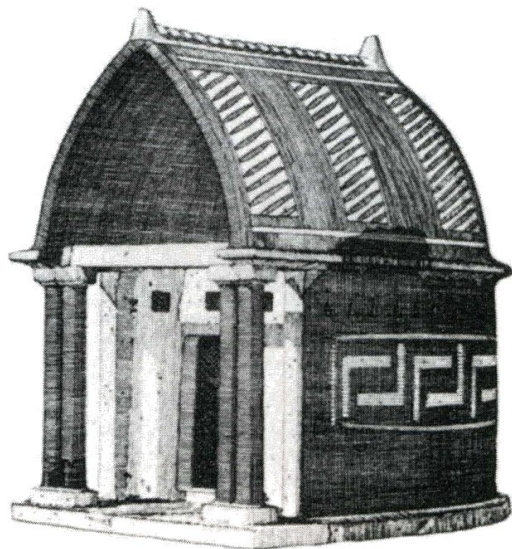
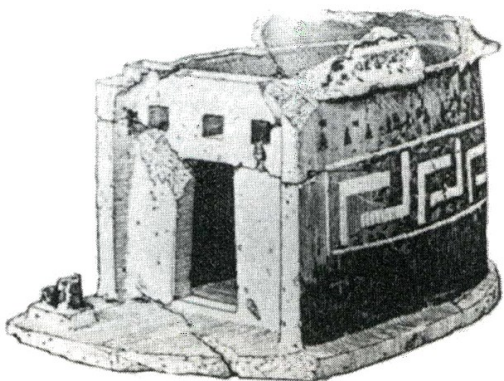

πήλινος αναθηματικός οικίσκος  
από το Ηραίο της Περαχώρας  
(μέσα 8<sup>ου</sup> αι. π.Χ.)

πήλινος αναθηματικός οικίσκος  
από το Ηραίο του Άργους  
(τέλος 8ου αι. π.Χ.)



# TEMPLE AT KALAPODI, 570 BC

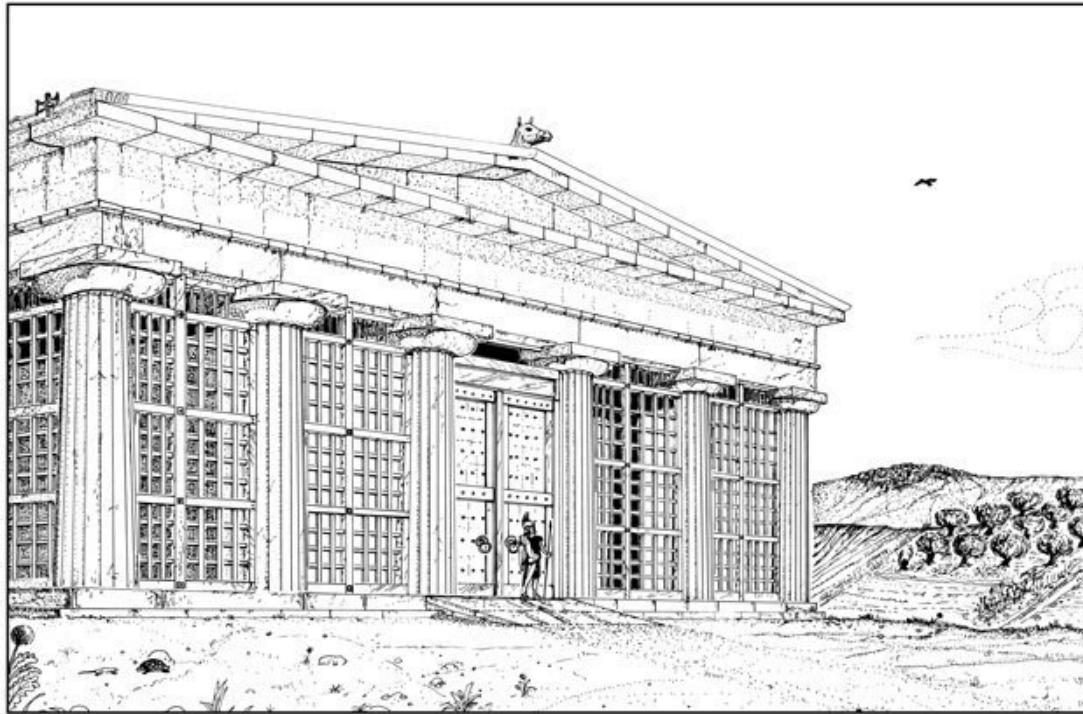

# ΑΡΧΑΙΟΤΕΡΟΣ ΝΑΟΣ ΑΦΑΙΑΣ ΣΤΗΝ ΑΙΓΙΝΑ, 560 Π.Χ.



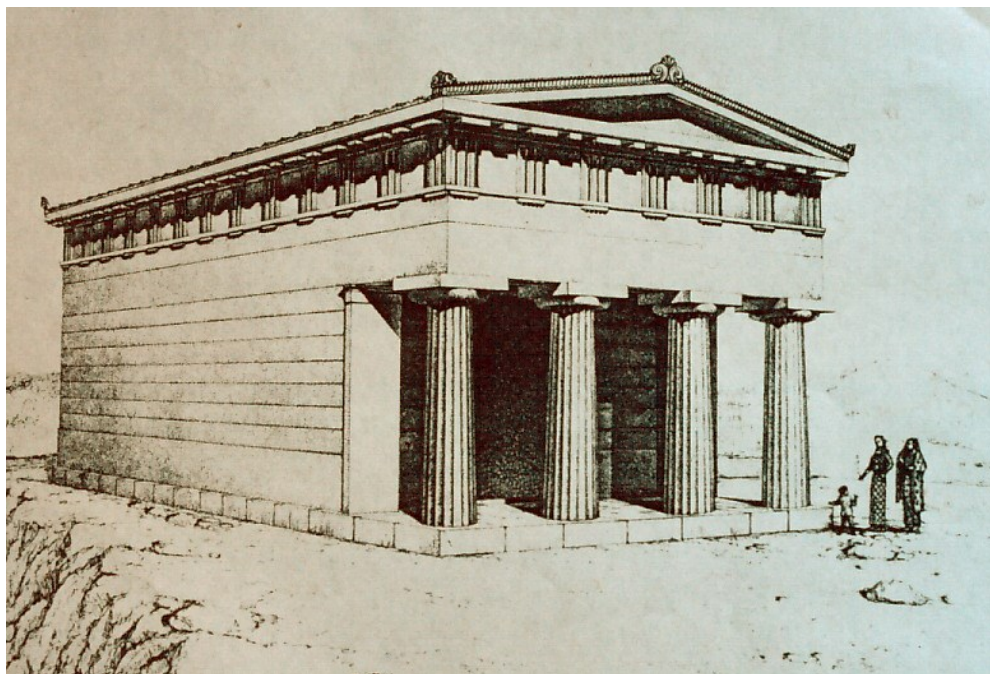

ΑΡΗΑΙΑ, ΑΙΓΙΝΑ

OLDER TEMPLE

(περ. 570 π.Χ.)

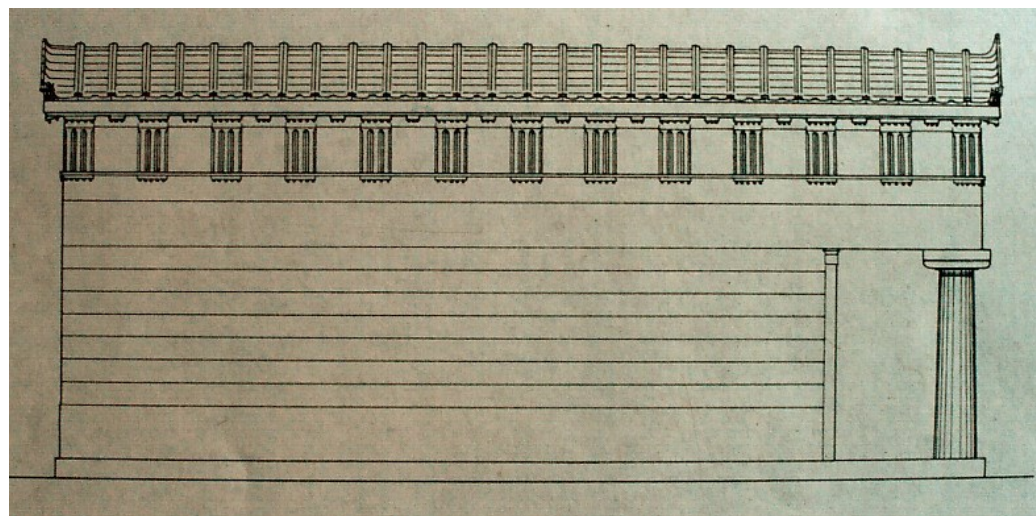

# PEDIMENT SCULPTURES



# ACROTERIA FINIALS

- TRIPODS, GORGO, NIKE,  
MONSTERS...





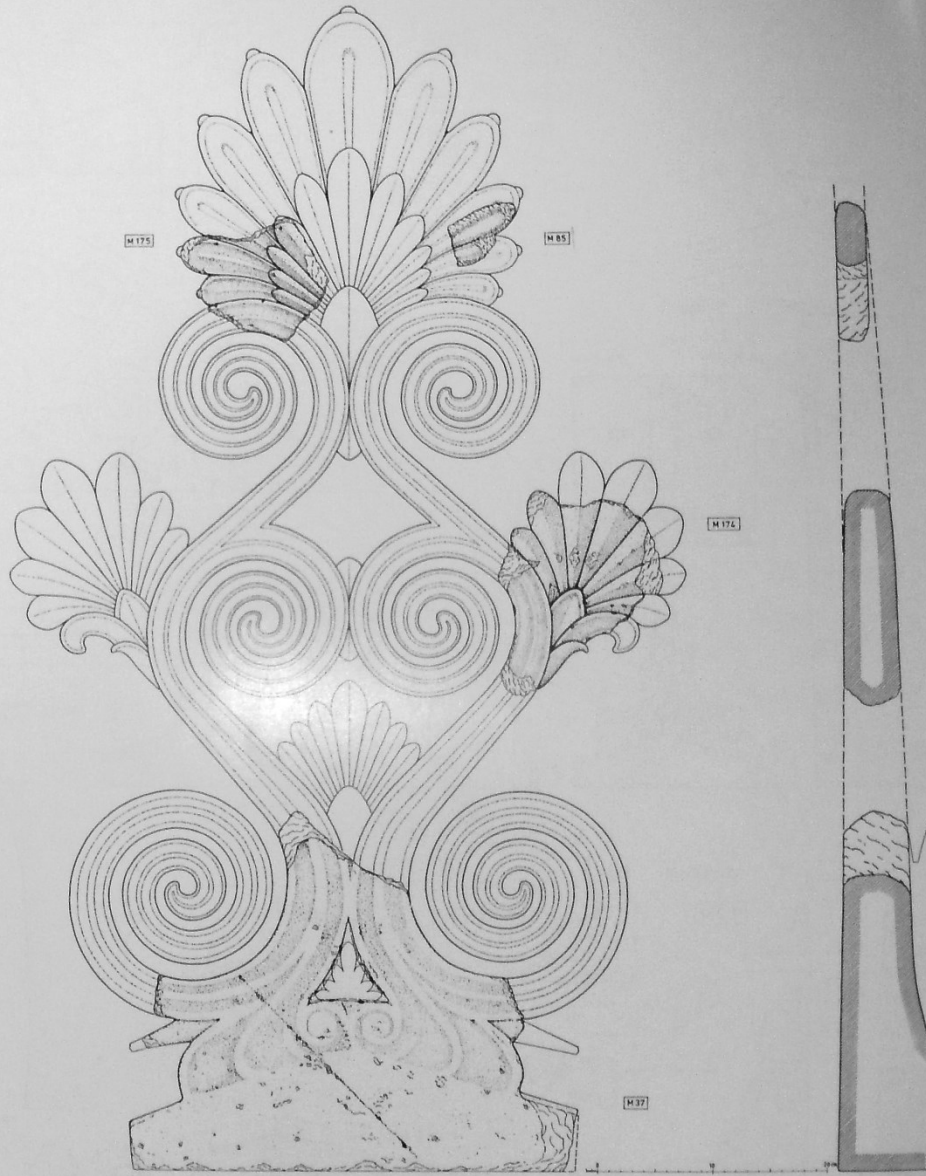

Rekonstruiertes Mittelakroter der Front

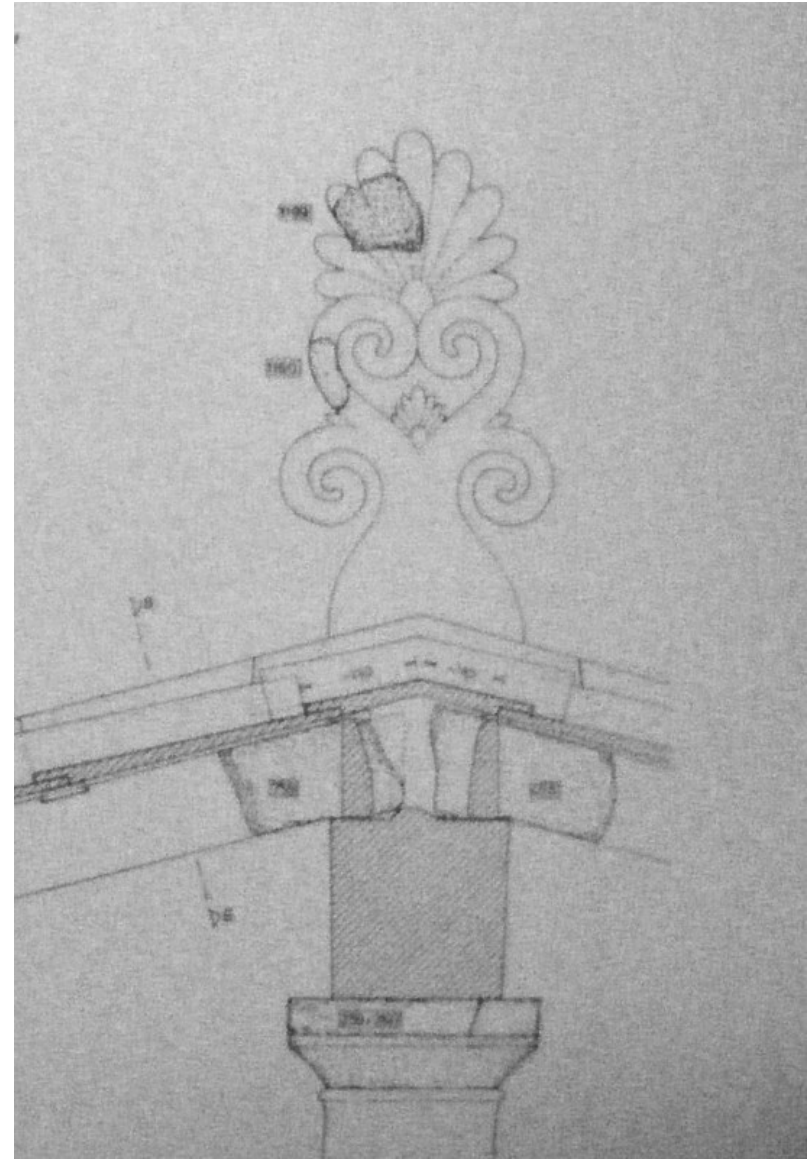

# ACROTERIA IN THE ISLANDS

# TEMPLE OF ZEUS, OLYMPIA



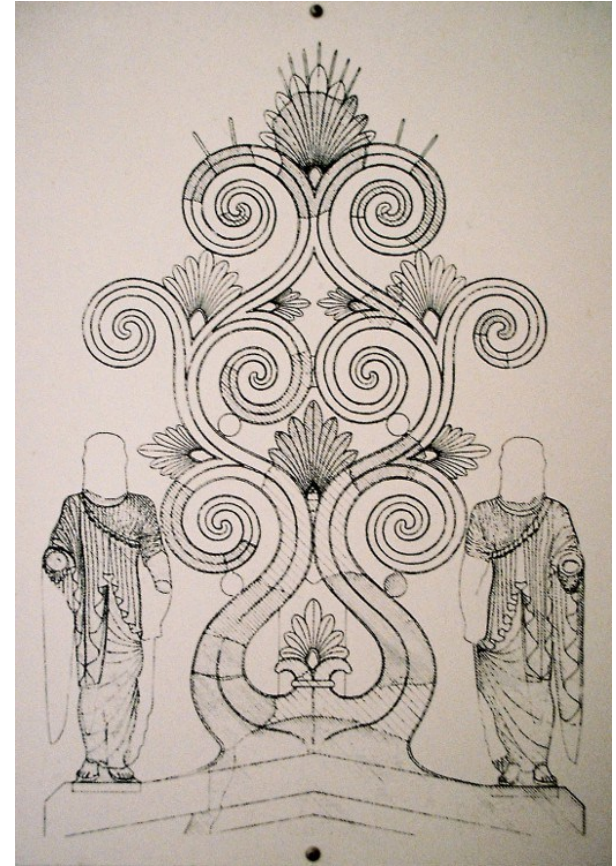

APHAIA TEMPLE, AEGINA



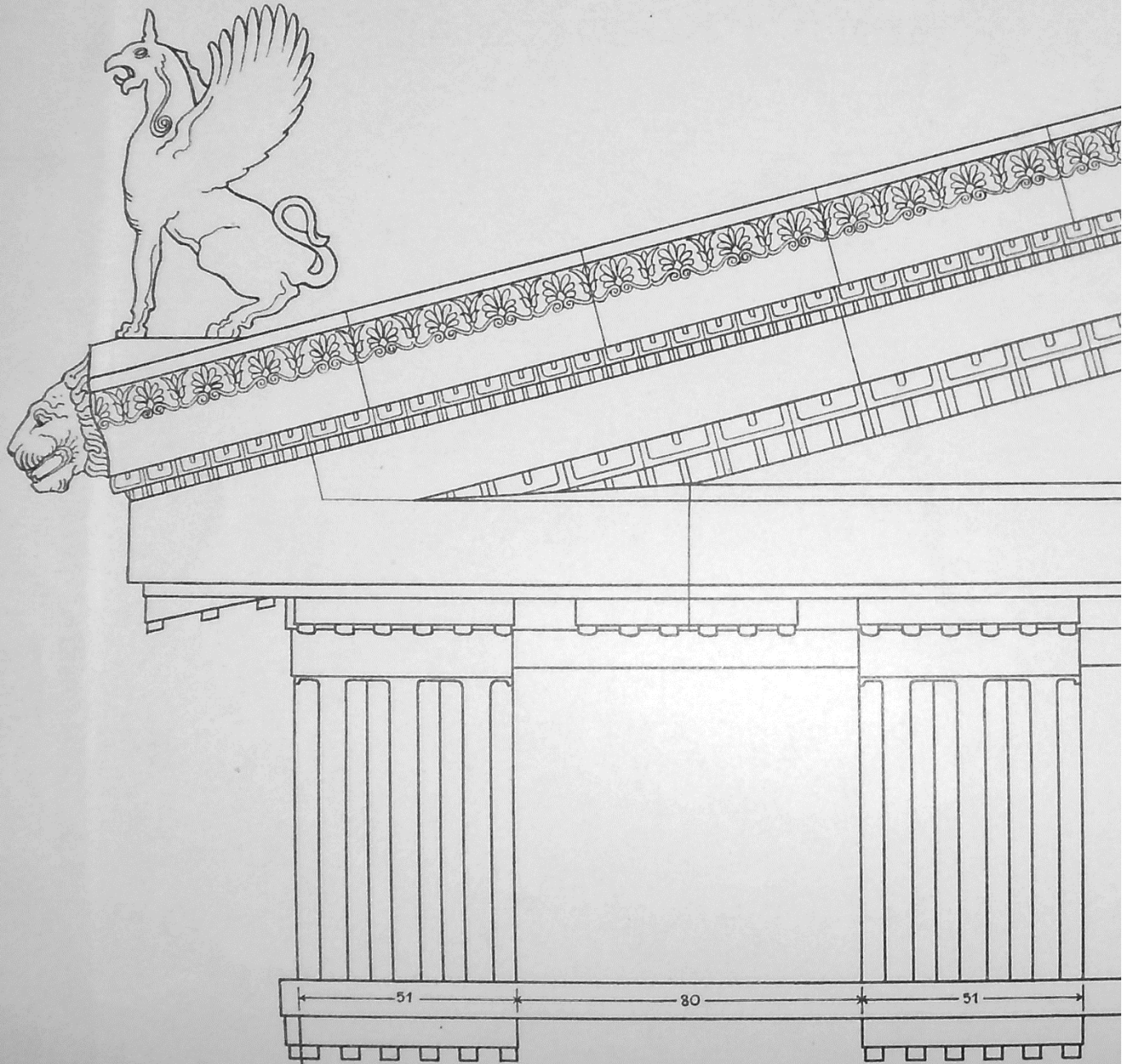

# PARTHENON



# THOLOS EPIDAUROS

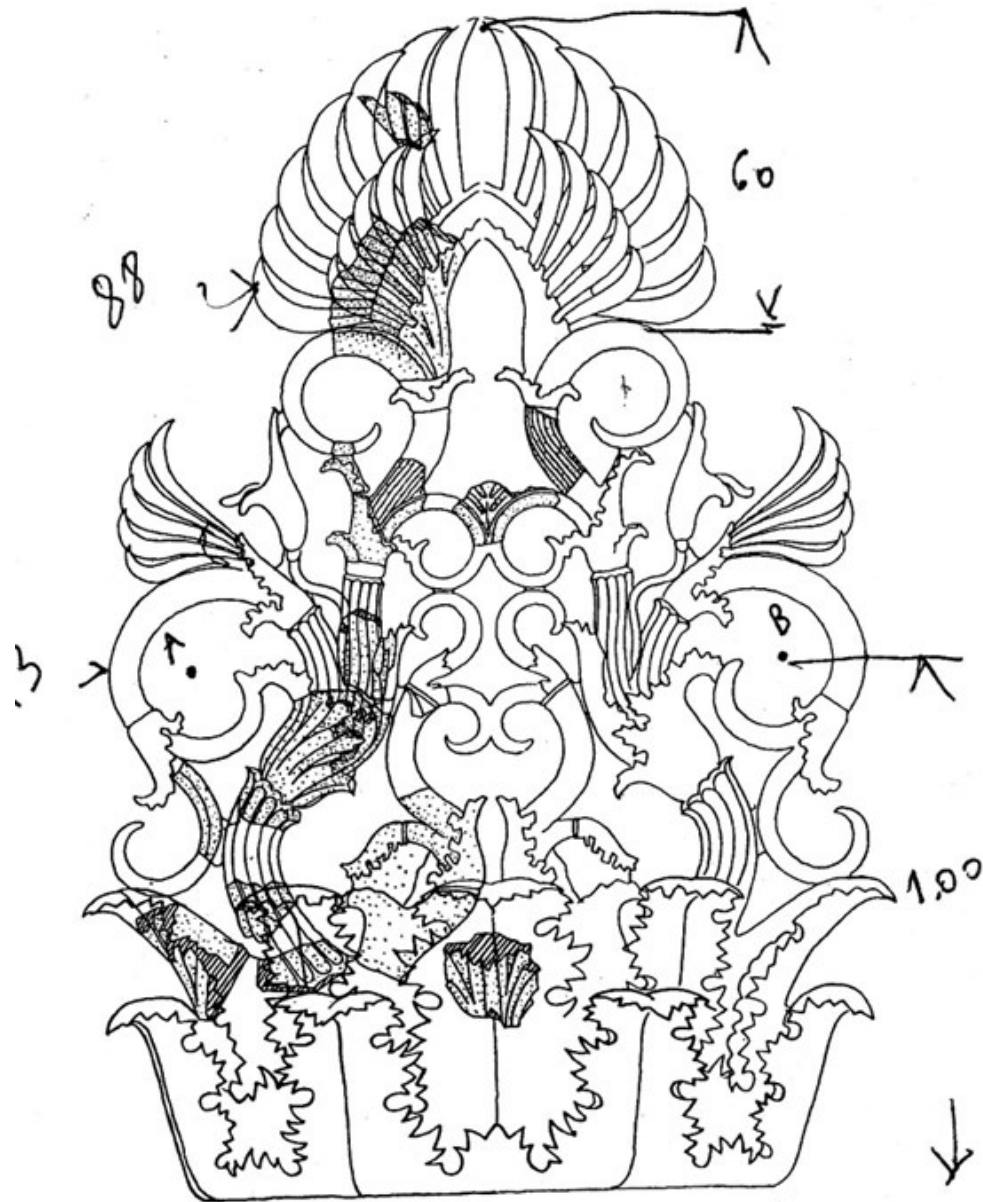



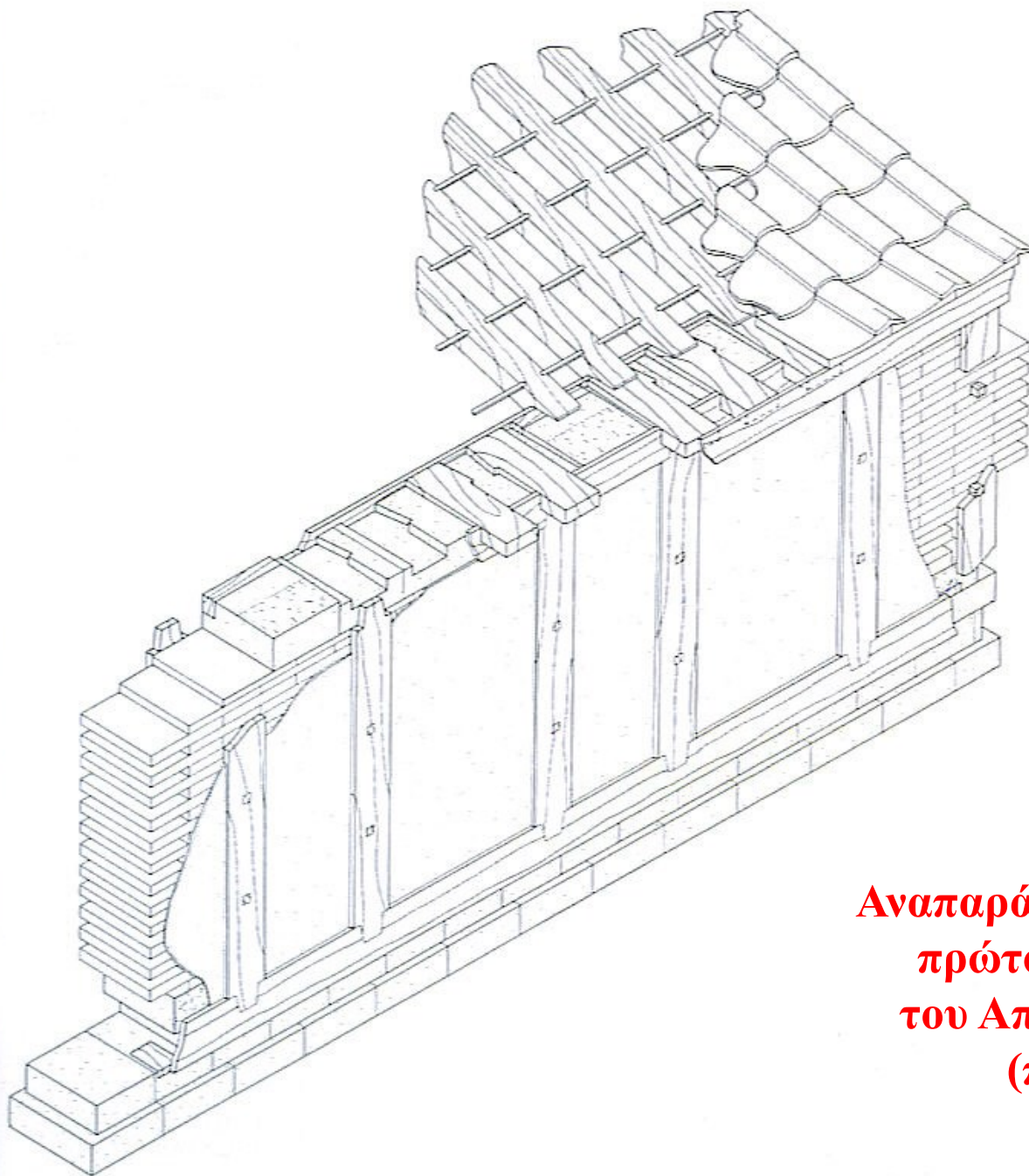

**Αναπαράσταση της ανωδομής του  
πρώτου, προ-δωρικού ναού  
του Απόλλωνος στην Κόρινθο  
(περ. 680-650 π.Χ.)**

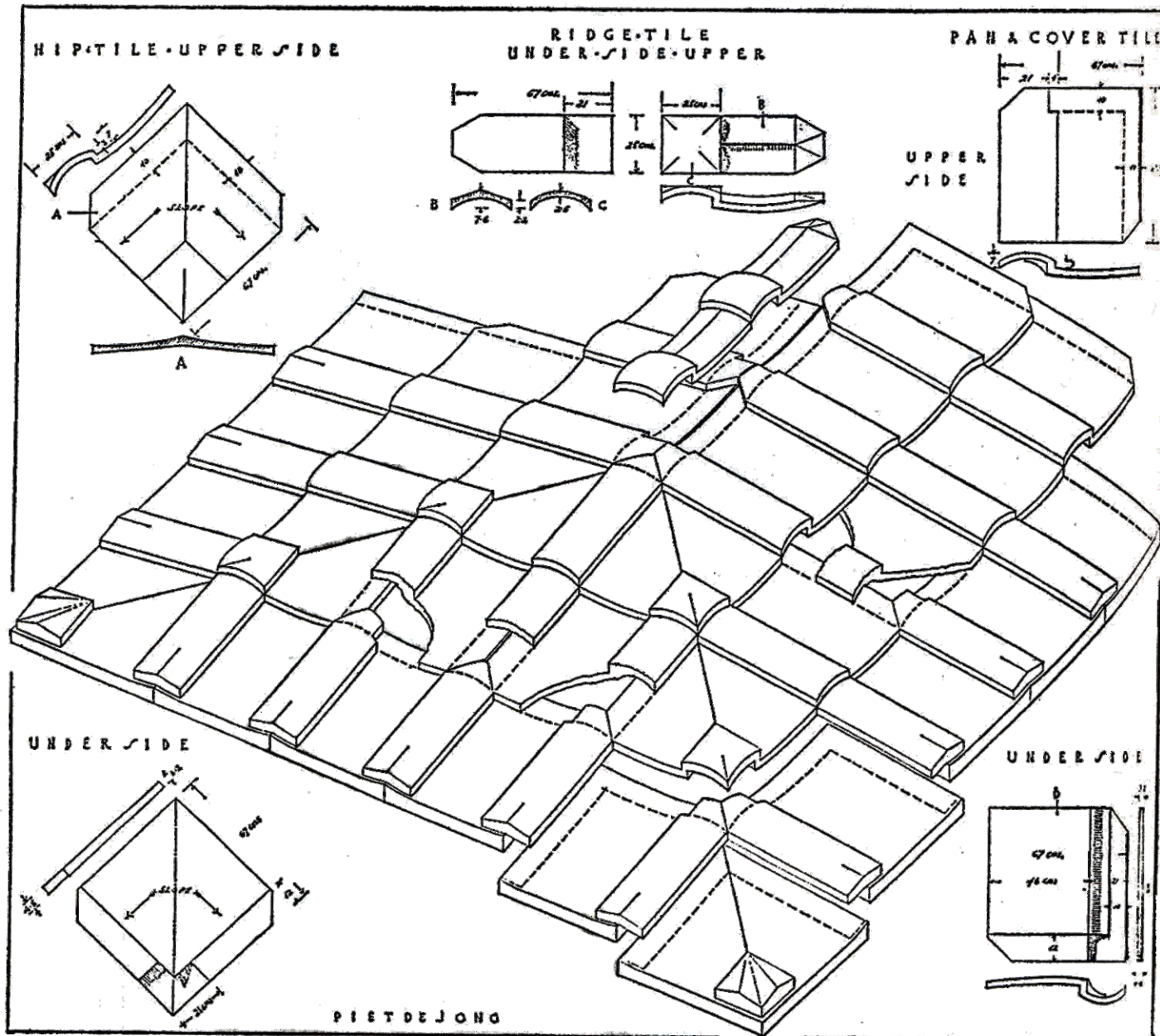

υποθετική  
αναπαράσταση της  
στέγης του πρώτου  
ναού του Απόλλωνα  
στην Αγορά της  
Κορίνθου  
(περ. 680-650 π.Χ.)









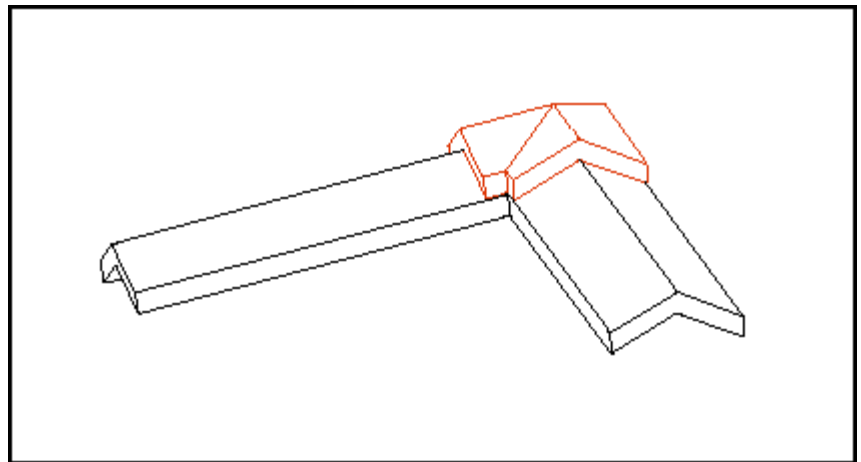
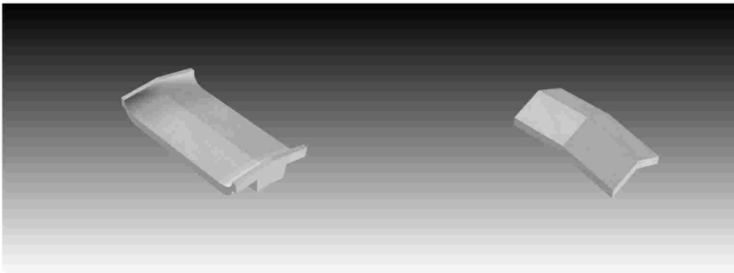
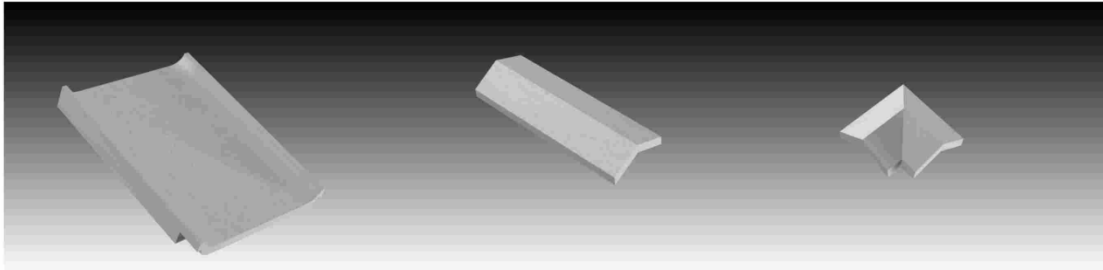
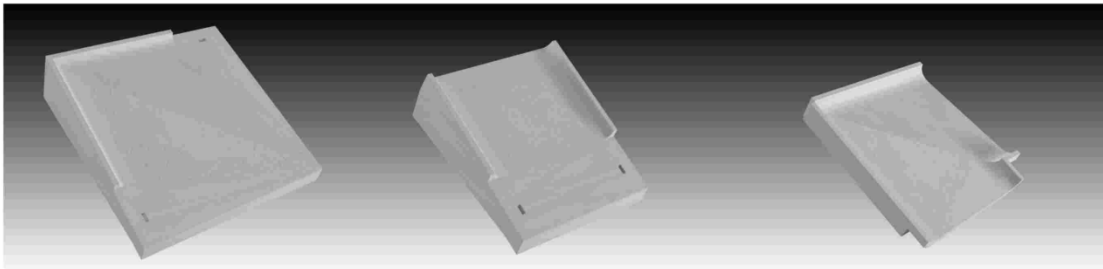





# WATER SPOUTS



a



b

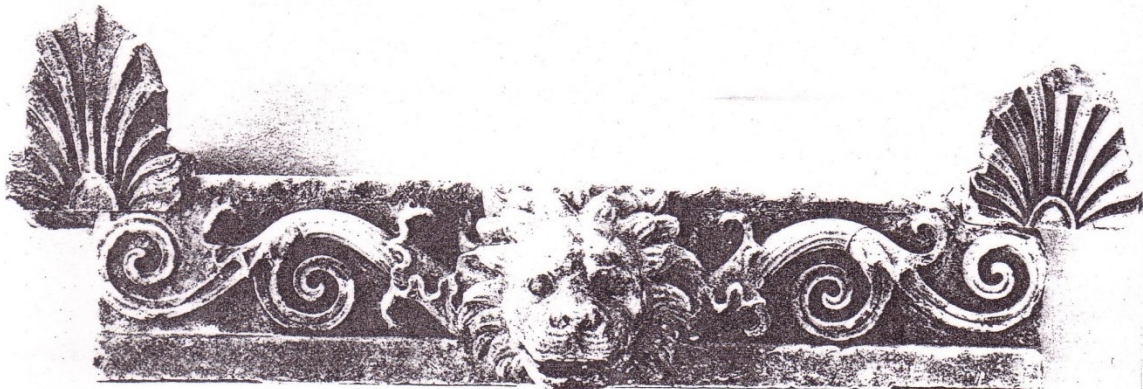

c

Chéneaux péloponnésiens. a : temple de Poséidon à l'Isthme (IV<sup>e</sup> s.) ; b : temple d'Apollon à Delphes (IV<sup>e</sup> s.) ; c : temple d'Athéna à Tégée (remarquer la moulure au sommet du panneau).



ABOVE EACH  
TRIGLYPH

